

VICINITY MAP
NOT TO SCALE

DEMOLITION NOTES:
GENERAL CONTRACTOR IS RESPONSIBLE FOR MAINTAINING ALL UTILITY SERVICES, DRAINAGE, ETC., TO THIS AREA OR ADJACENT AREAS DURING DEMOLITION AND CONSTRUCTION.

ALL DEBRIS FROM DEMOLITION ACTIVITIES SHALL BE REMOVED FROM THE SITE AND DISPOSED OF PROPERLY IN ACCORDANCE WITH ALL AGENCIES HAVING JURISDICTION.

THE EAST GROUP
Engineering • Architecture
Surveying • Technology
Corporate Office
324 Evans Street
Greenville, NC 27858
Tel 252.758.3746 Fax 252.830.3954
www.eastgroup.com
Branch Office
4325 Lake Boone Trail, Suite 311
Raleigh, NC 27607
Tel 919.784.9330 Fax 919.784.9331
NC Engineering License No. C-0206
NC Architectural License No. 50213
NC Landscape Architectural License No. C-427

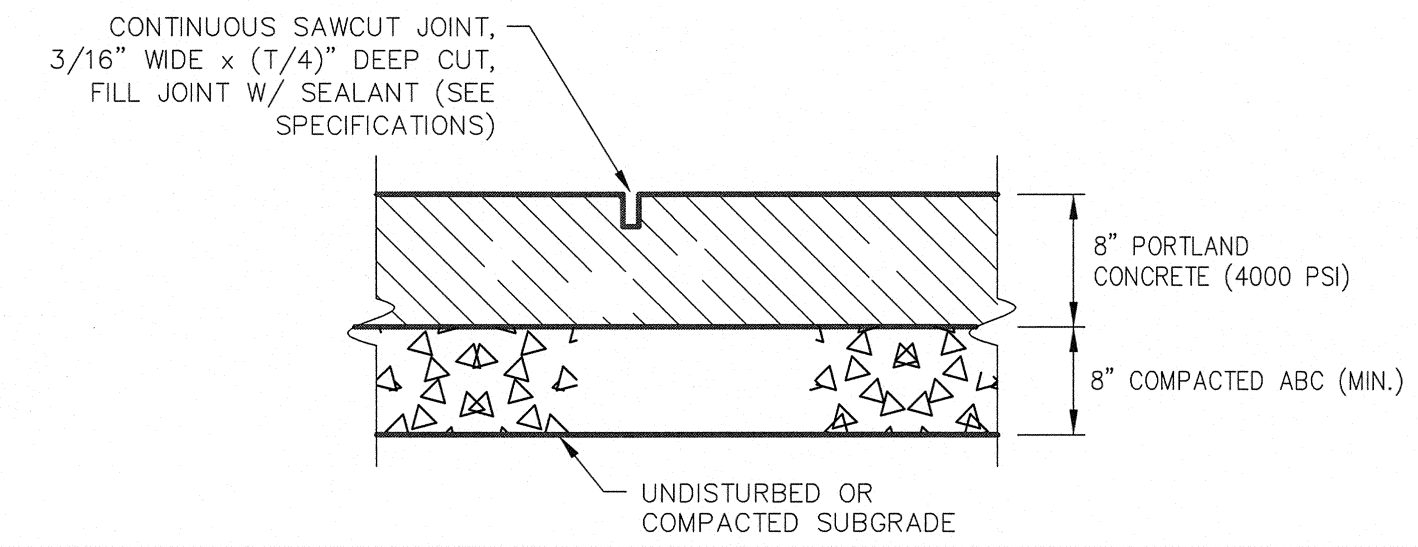
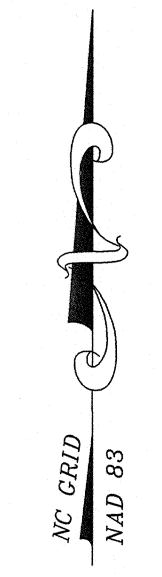

NOTE:
1. CONTROL JOINT IS TO BE USED WHERE SHOWN ON PLAN. USE A CONSTRUCTION JOINT AT ENDS OF POUR.

1 CONCRETE PAVEMENT SECTION
C1.1 N.T.S.

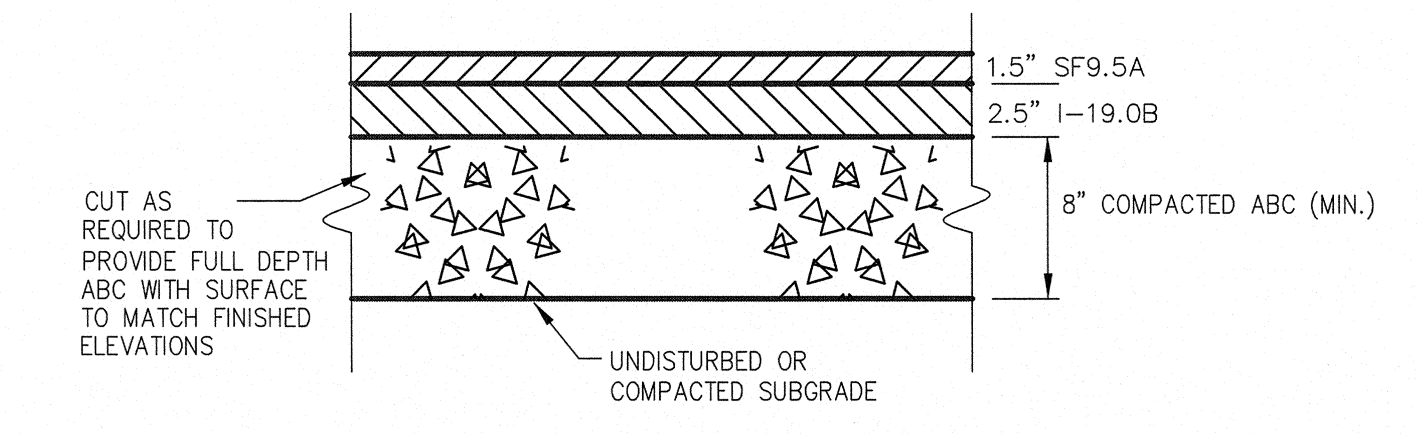

2 TYPICAL NEW ASPHALT PAVEMENT SECTION
C1.1 N.T.S.

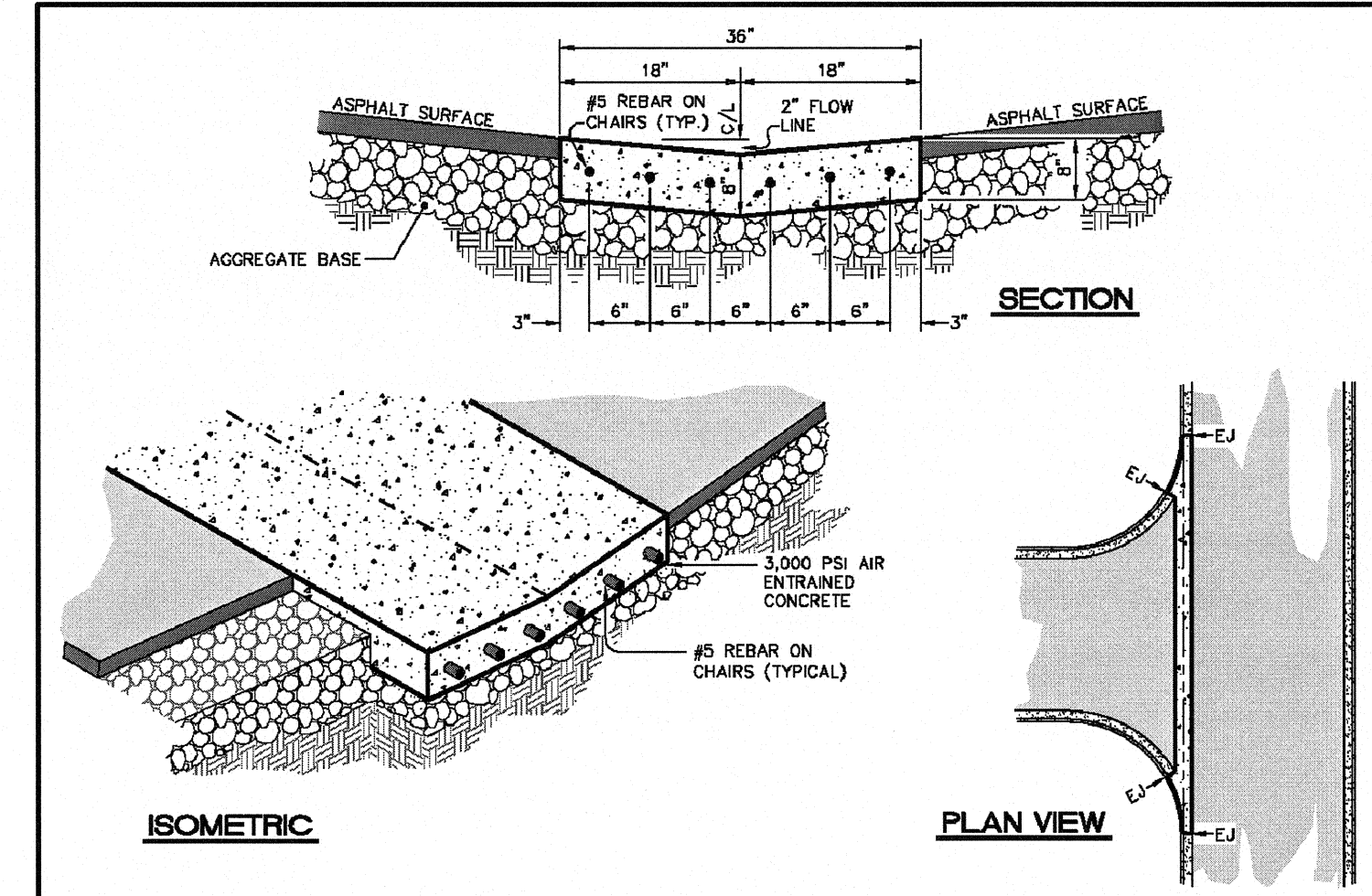

3 CONCRETE VALLEY GUTTER
C1.1 N.T.S.

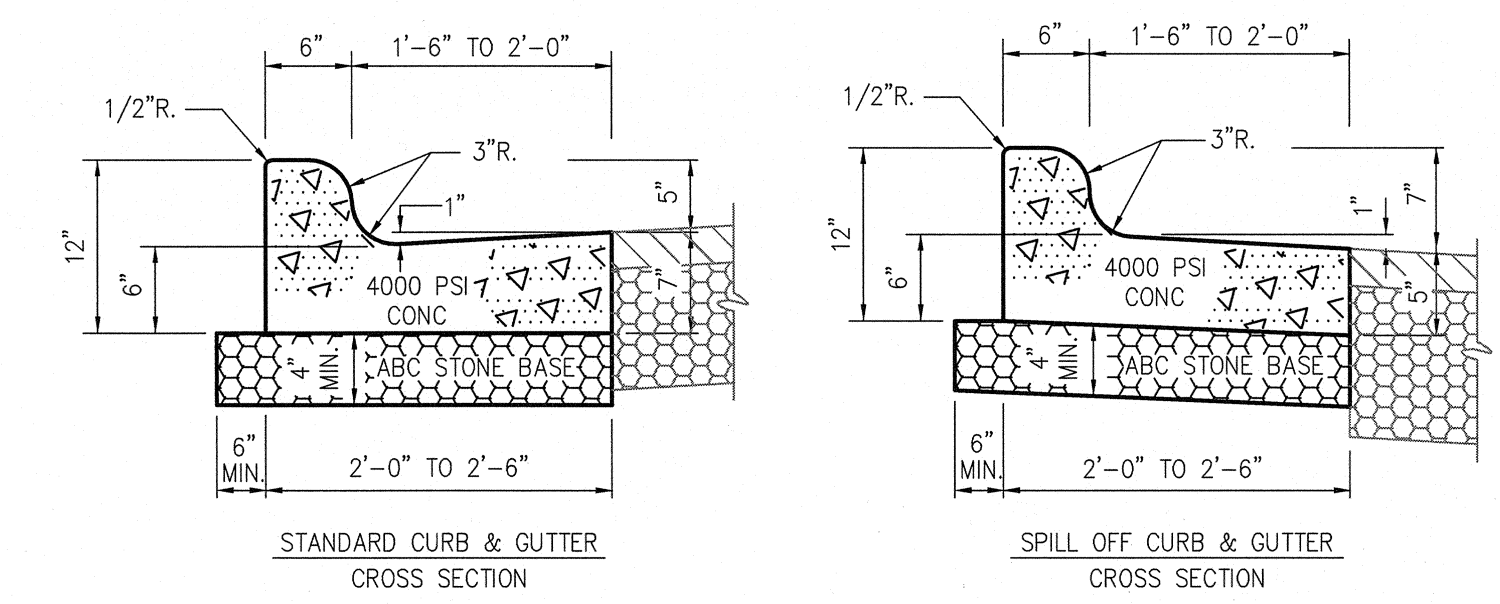

NOTE: USE "STANDARD TYPE" C&G UNLESS OTHERWISE NOTED ON PLANS.

4 TYPICAL CURB & GUTTER DETAIL
C1.1 N.T.S. (SPILL & STANDARD)

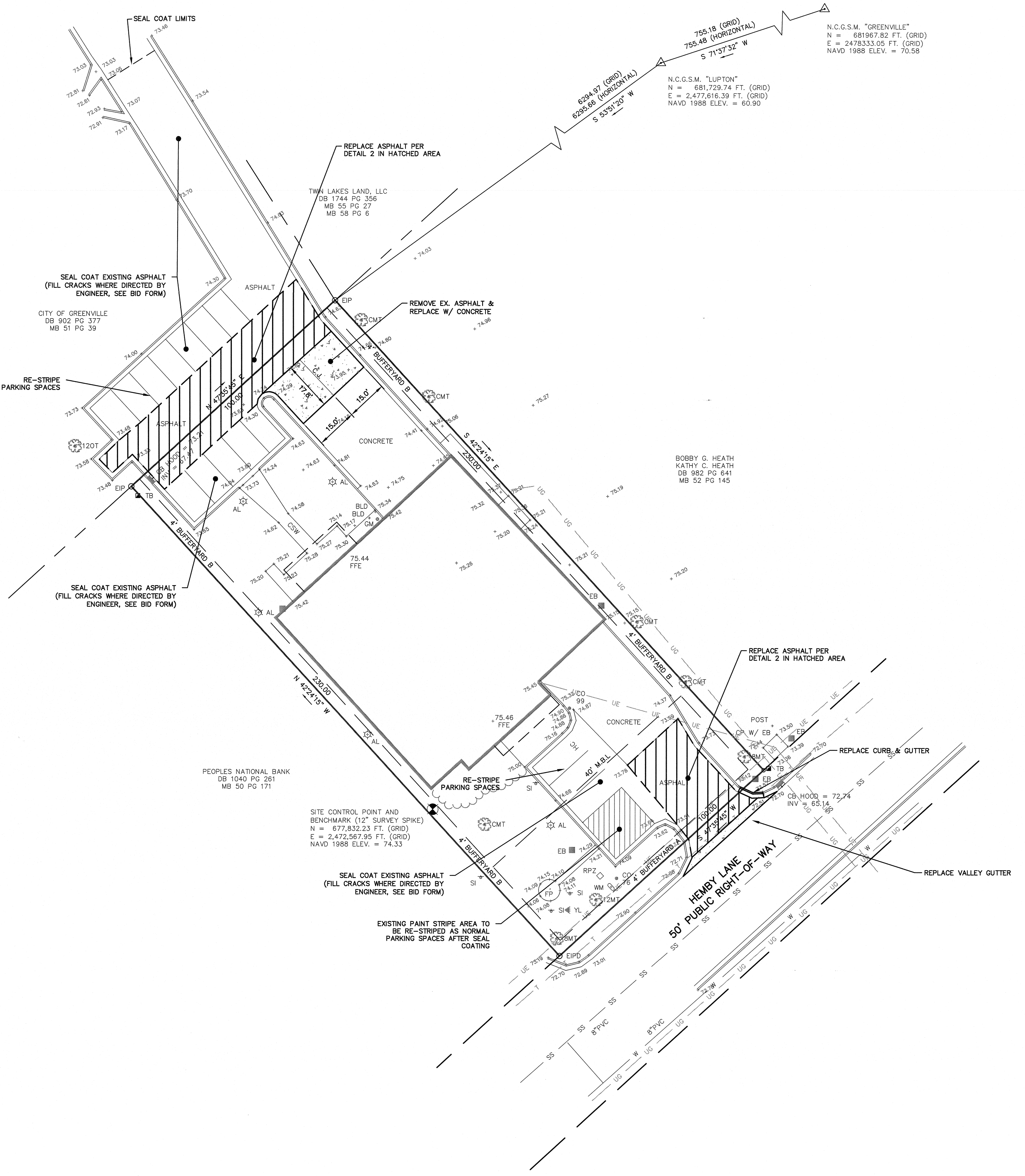

SITE DATA:

| | |
|----------------------|-------------------------------------|
| TOTAL ACREAGE | 0.528 AC. |
| ZONING | NO |
| OWNER NAME | CITY OF GREENVILLE |
| PROPERTY ADDRESS | 2490 HEMBY LANE |
| PROPERTY DESCRIPTION | FIRE STATION #2 |
| PARCEL No. | 59637 |
| PIN No. | 467274863 |
| DEED BOOK / PAGE | DB 871 PG 624 |
| MAP BOOK | MB 50 PG 171 |
| MUNICIPALITY | GREENVILLE |
| TOWNSHIP | GREENVILLE |
| NEIGHBORHOOD | 004113 |
| BUILDING TYPE/USE | OFF CONST (OTHERMUNICIP) |
| IMPERVIOUS AREA | PROPOSED (NO NET INCREASE) 0.00 AC. |
| DISTURBED AREA | 0.02 AC. |

LEGEND

| | |
|------|--------------------------|
| COL | = COLUMN |
| CONC | = CONCRETE PAD |
| CSW | = CONCRETE SIDEWALK |
| EIP | = EXISTING IRON PIPE |
| EX | = EXISTING |
| FFE | = FINISH FLOOR ELEVATION |
| FP | = FLAG POLE |
| OT | = OAK TREE |
| S | = SIGN |
| TYP. | = TYPICAL |

- SITE PLAN NOTES:**
1. ALL PARKING LOT/DRIVE DIMENSIONS, ANGLES AND RADII ARE TO BACK OF CURB WHERE APPLICABLE.
 2. PARKING LOT SHALL BE STRIPED IN ACCORDANCE WITH THIS PLAN.
 3. ALL REQUIRED IMPROVEMENTS SHALL CONFORM TO THE CITY OF GREENVILLE MANUAL OF STANDARD DESIGNS AND DETAILS (MSDD).
 4. SITE SHALL MEET ALL RELATED ACCESSIBILITY REQUIREMENTS.
 5. CONTRACTOR MUST NOTIFY ONE-CALL CENTER, INC. (NC ONE-CALL) (1-800-632-4949) AT LEAST 48 HOURS PRIOR TO THE START OF EXCAVATION OR TRENCHING TO HAVE ALL UNDERGROUND UTILITIES LOCATED.

- SURVEY NOTES:**
- 1) THIS PROPERTY IS SUBJECT TO THE TAR/PAMLICO RIVER RIPARIAN BUFFER RULES.
 - 2) THE SURVEYOR MAKES NO GUARANTEE THAT THERE ARE NO OTHER EASEMENTS THAT MAY BENEFIT OR BURDEN THE SUBJECT PROPERTY.
 - 3) THIS PROPERTY IS LOCATED IN ZONE X AND IS NOT IN A SPECIAL FLOOD HAZARD AREA AS TAKEN FROM N.F.I.P. RATE MAP DATE JULY 7, 2014 COMMUNITY PANEL NUMBER 3720467700K.
 - 4) SPOT ELEVATIONS & CONTOURS ESTABLISHED FROM N.C.G.S. MONUMENTS "LUPTON" AND "GREENVILLE".
 - 5) PROPERTY LINES SHOWN AS DASHED REPRESENT LINES NOT SURVEYED.
 - 6) THE SURVEYOR DID NOT DELINEATE OR LOCATE ANY WETLANDS ON THE SUBJECT PROPERTY.

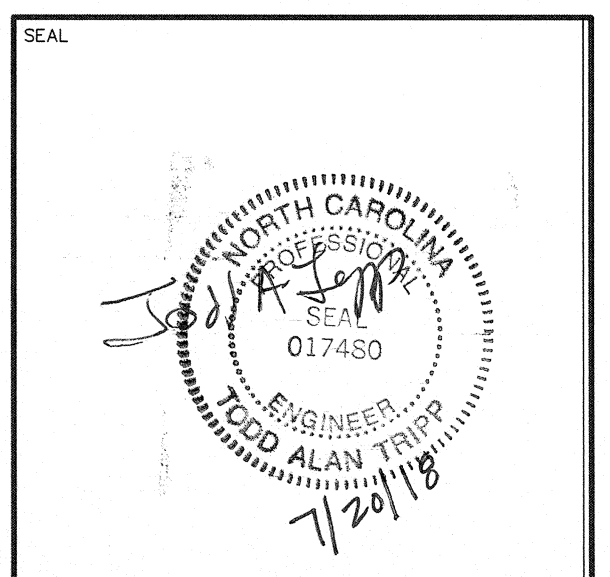

| REV. | DATE | DESCRIPTION | BY | CHK |
|------|---------|------------------|-----|-----|
| A | 5-18-18 | ISSUE FOR REVIEW | SLJ | TAT |
| B | 7-19-18 | ISSUE FOR BID | SLJ | TAT |

REG PROJECT NO. 20180047
CLIENT PROJECT NO. -
PROJECT TITLE
**CITY OF GREENVILLE
FIRE STATION NO. 2
2490 Hemby Lane**
BASE BID
DRAWING TITLE
**SITE PLAN &
DETAILS**

DRAWING NO.
C1.1

OWNER
CITY OF GREENVILLE
2490 HEMBY LANE
GREENVILLE, NC 27858

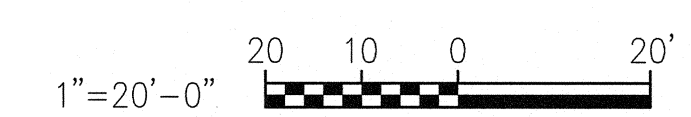

THIS DRAWING IS THE PROPERTY OF THE EAST GROUP, P.A. ANY USE, REUSE, REPRODUCTION, DISPLAY OR SALE OF THIS DRAWING WITHOUT WRITTEN CONSENT OF THE EAST GROUP, P.A. IS STRICTLY PROHIBITED. © COPYRIGHT, THE EAST GROUP, P.A. 2018