



Agenda

Greenville City Council Workshop

October 10, 2022

4:00 PM

City Hall Conference Room 337, 200 West 5th Street

Assistive listening devices are available upon request for meetings held in the Council Chambers. If an interpreter is needed for deaf or hearing impaired citizens, please call 252-329-4422 (voice) or 252-329-4060 (TDD) no later than two business days prior to the meeting.

I. Call Meeting To Order

II. Roll Call

III. Approval of Agenda

IV. New Business

1. Public Art Presentation for Emerald Loop Shelter on the Town Common
2. Discussion of Housing and Community Development Programs
3. Presentation of the Integrated Mobility & Enhancement Plan (IMEP) for the Transit Division of the Public Works Department

V. Adjournment



City of Greenville, North Carolina

Meeting Date: 10/10/2022

Title of Item: Public Art Presentation for Emerald Loop Shelter on the Town Common

Explanation: In 2018, the City of Greenville was designated a SmART City and the Pitt County Arts Council was awarded a SmART Initiatives grant by the North Carolina Arts Council. A SmART City Resource Team was formed with many partners and stakeholders from both the private and public sectors. The Emerald Loop project was chosen as the project that would transform our Center City through the Arts.

In 2019, Haddad/Drugan was chosen by a Request for Qualifications (RFQ) process to create the Emerald Loop Vision Plan, a plan that took a year of research, stakeholder meetings, and community engagement. The Emerald Loop Vision Plan and the implementation timeline were approved by City Council in August of 2020.

This is the 2nd series of projects as part of the Emerald Loop, after the implementation of the first two intersection murals. The proposed project will be a shelter and stop along the Emerald Loop as well as the African-American Cultural Trail of Greenville-Pitt County. The shelter will be composed of a steel shelter with a bench swing for people to sit, as well as an accessible space for a wheelchair or people standing underneath. The back portion of the shelter is a series of vertical fins or blinds where on one side there is a reproduction of a photograph that was taken when the Shore Drive neighborhood was in existence, showing houses along 1st Street with their front porches front and center. Haddad/Drugan have colorized the photograph and as color changing LED lights are shown on it, it creates an animated feeling of the street front. The fins will have the ability to be manually rotated, and when opened will provide a view to the current Town Common, and when closed on the opposite side will show a "vision" of the Town Common through the artwork of a Black Creative of Pitt County who will be chosen through the RFQ Process. The last component of the shelter will be an audio recording that will play at the touch of a button with African-American spirituals being sung by local Black musicians.

In 2021, the Pitt County Arts Council at Emerge was awarded the National Endowment for the Arts "Our Town" grant for this project. This was one of only 60 awarded throughout the nation. This design will be brought back to the City Council for approval before installation. Projected implementation is Spring 2023.

Fiscal Note: Approximately \$40,000 is included in the City of Greenville's approved Fiscal Year 2022-23 Budget for this project.

Recommendation: Hear the Proposed Public Art Project and bring back to a City Council meeting in November 2022 for approval

ATTACHMENTS

 [PCAC_TOWN COMMON EMERALD LOOP SHELTER_DESIGN_sm.pdf](#)

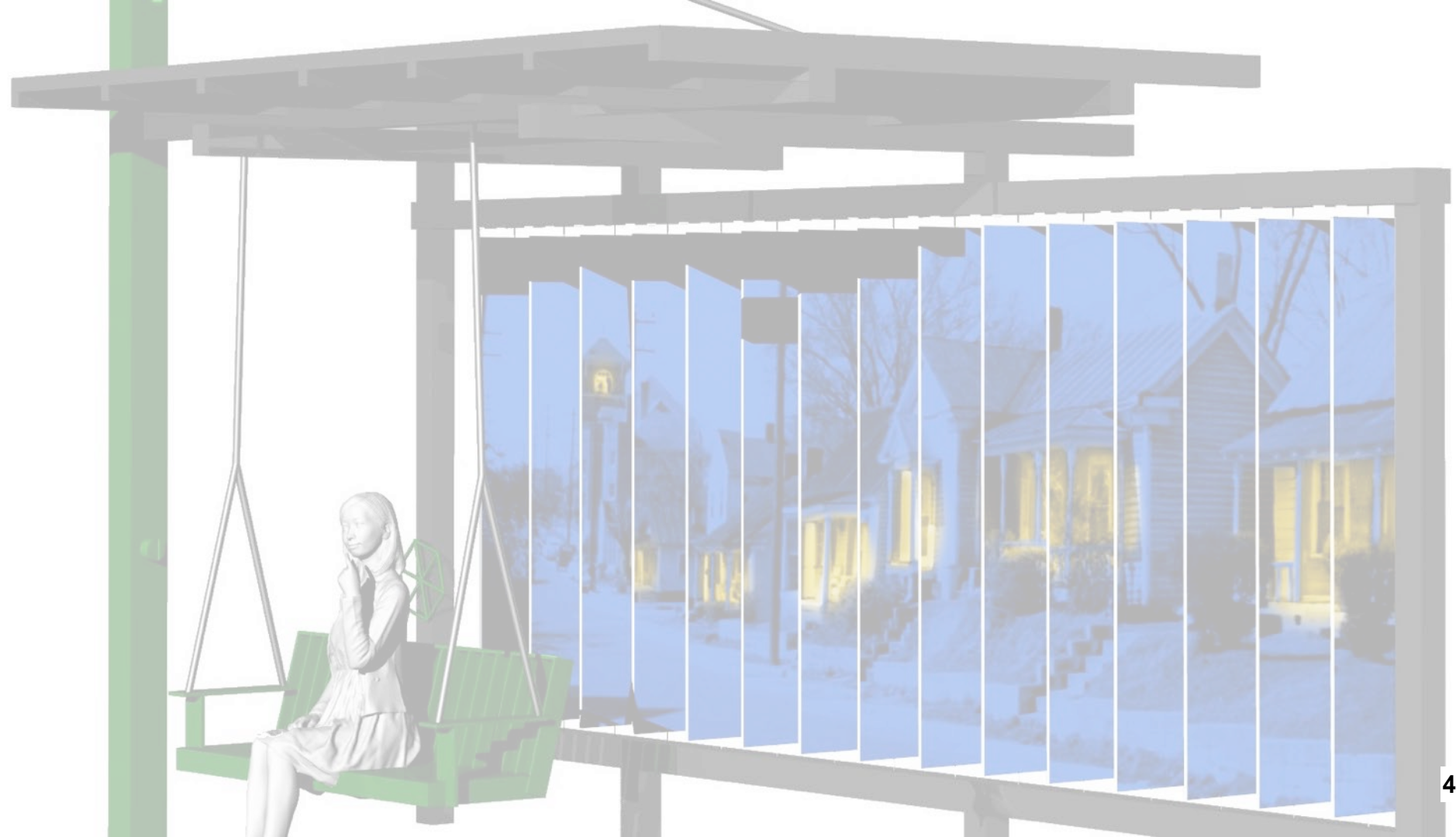

Art Shelter Locations

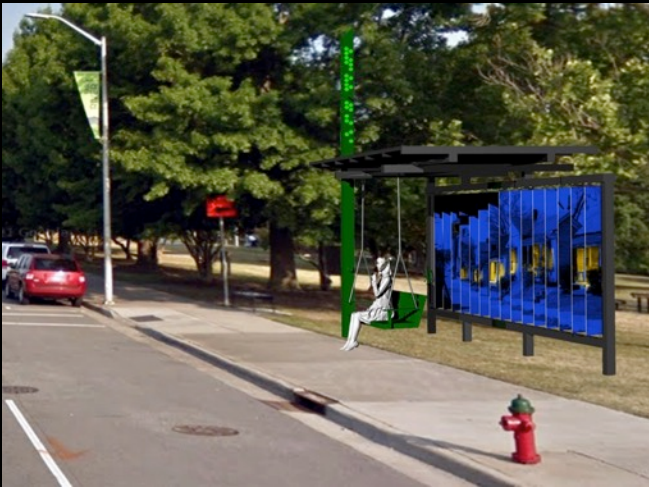
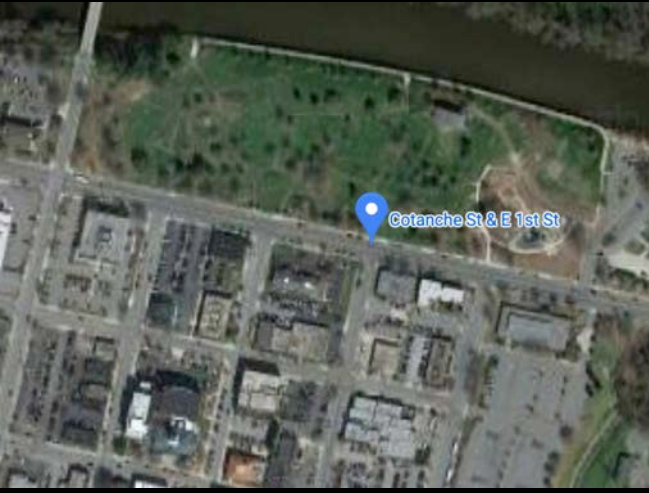

1st and Cotanche Shelter Location



Emerald Loop Marker Pole

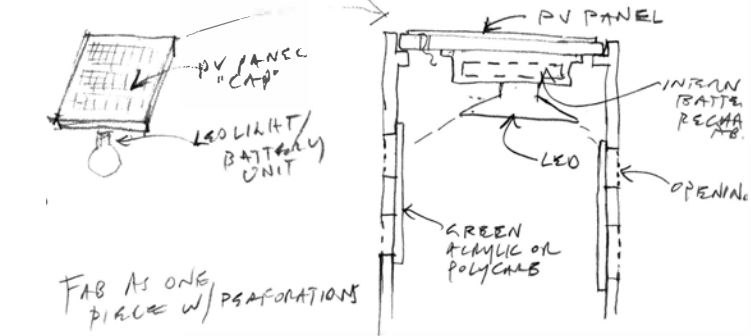
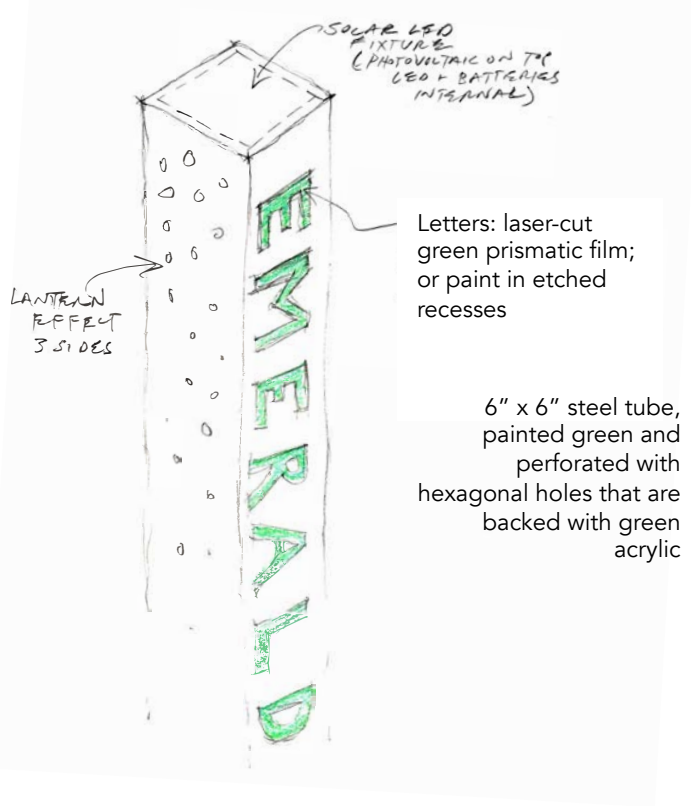

Solar-powered LED in cap backlights green acrylic hexagona

Shelter canopy may require suspension rod from ~6" tube; for poles with no shelter, 4" tube may be possible



Earlier model, with reflective stainless steel finish

Shelter Components

Emerald Loop Marker Pole

Green acrylic skylight in roof

Speaker in ceiling

Wheel to rotate fins

Button to activate sound

Swing, 5' long, painted green

Concrete pad

Frame: steel painted charcoal gray or stainless steel with blast finish

Suspension rod

Lenticular Fins:
1' x 6' aluminum or steel plate with printed images on both faces; either rotating or stationary



Shelter Interior Details

Green acrylic skylight in roof

Speaker in ceiling

LEDs in frame to illuminate fins

Lenticular Fins

Wheel to rotate fins

Button to activate sound

Swing, 5' long, painted green

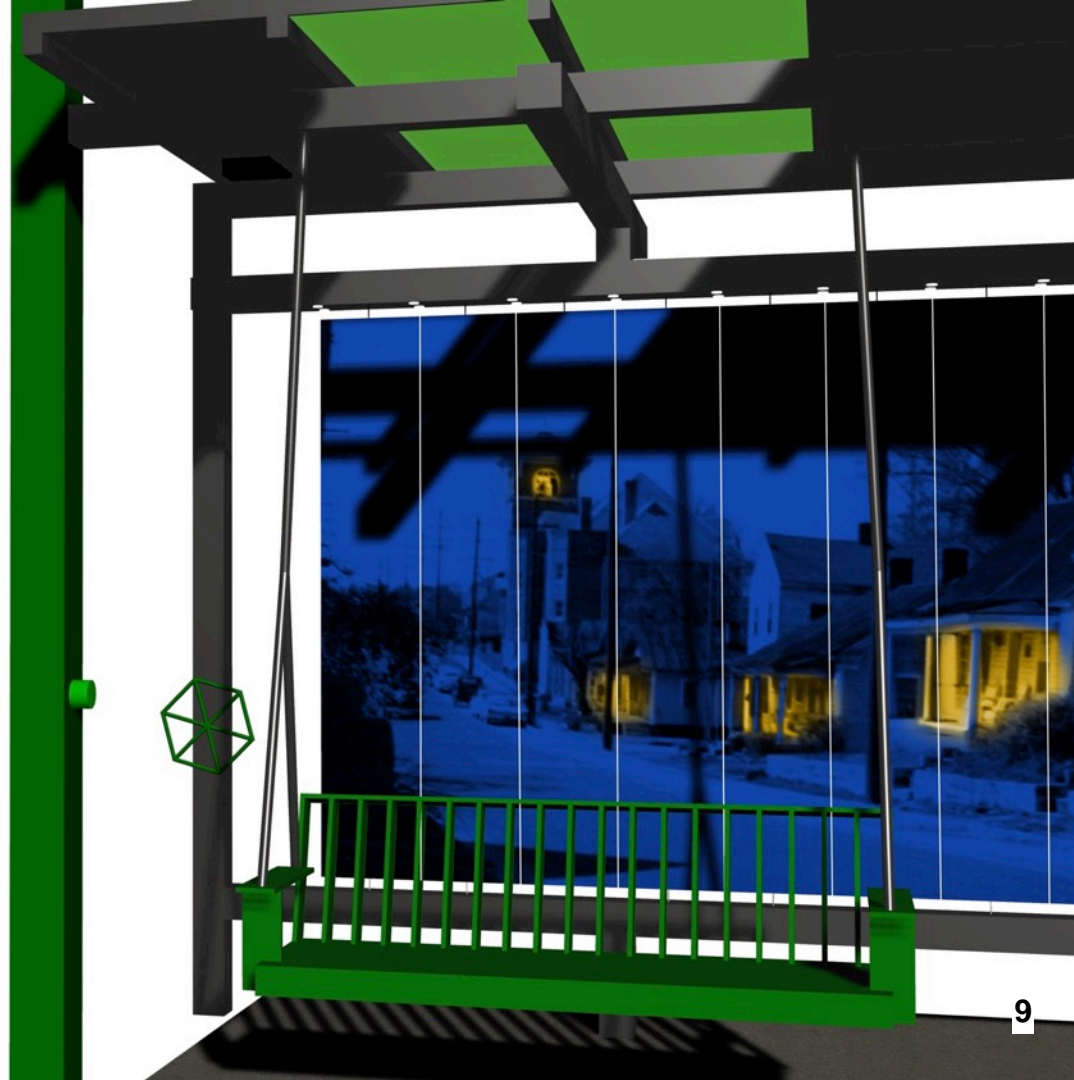

Shelter Plan

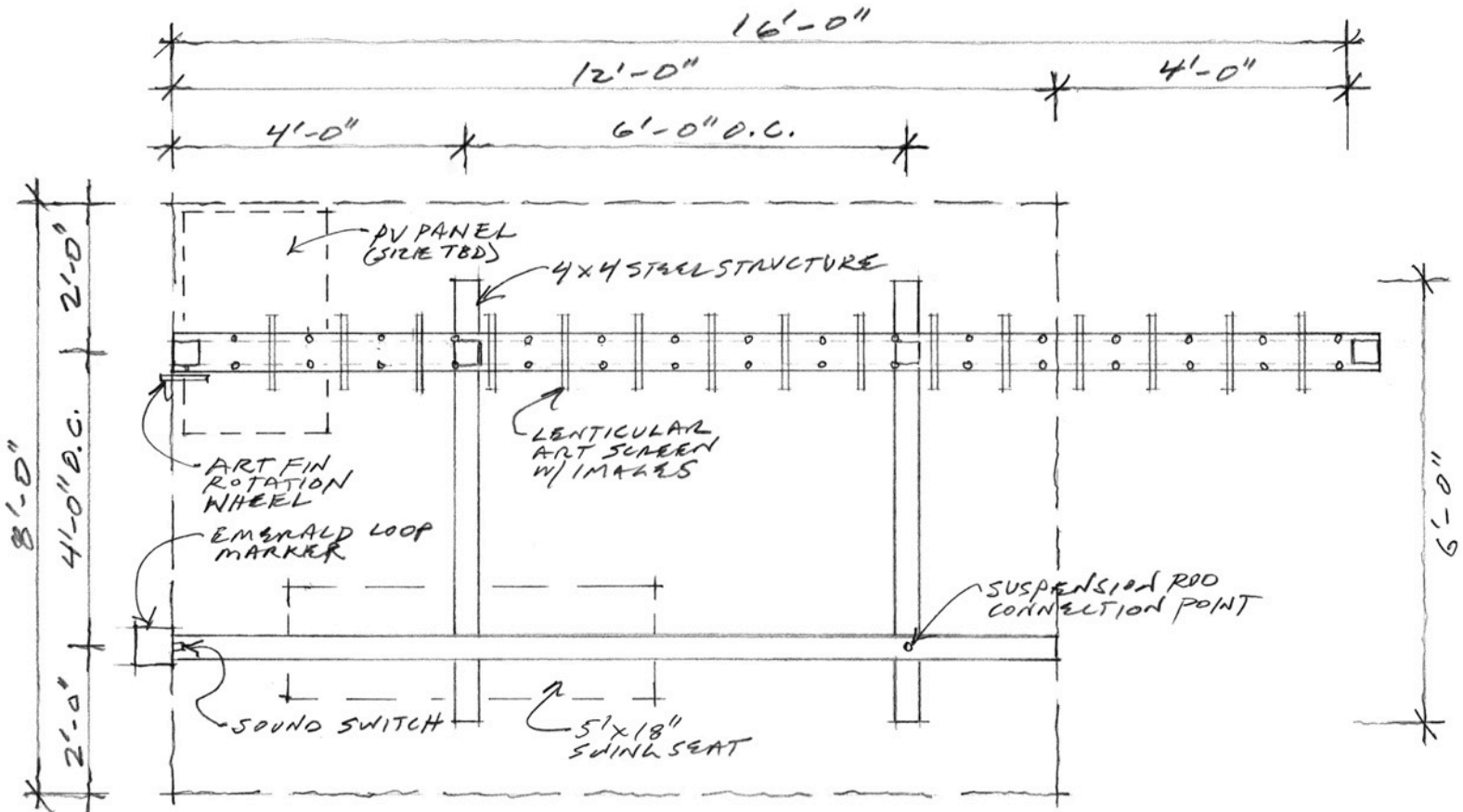

Shelter Elevations

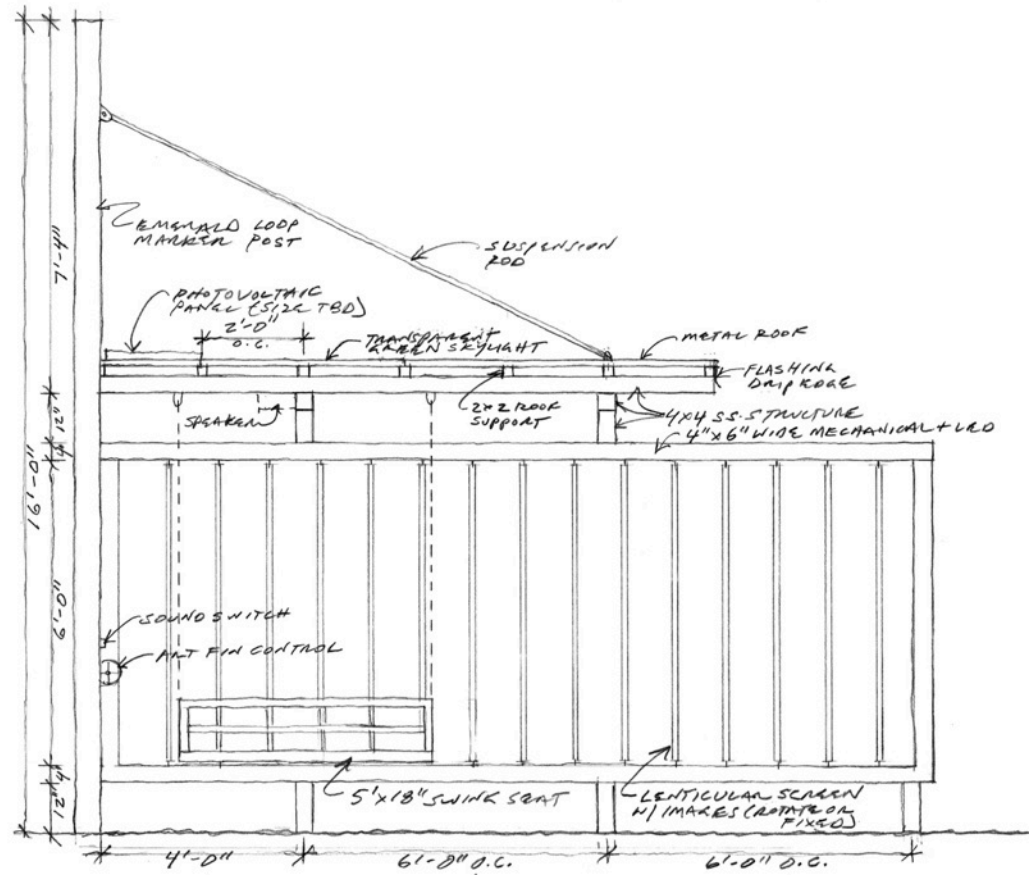

Front Elevation

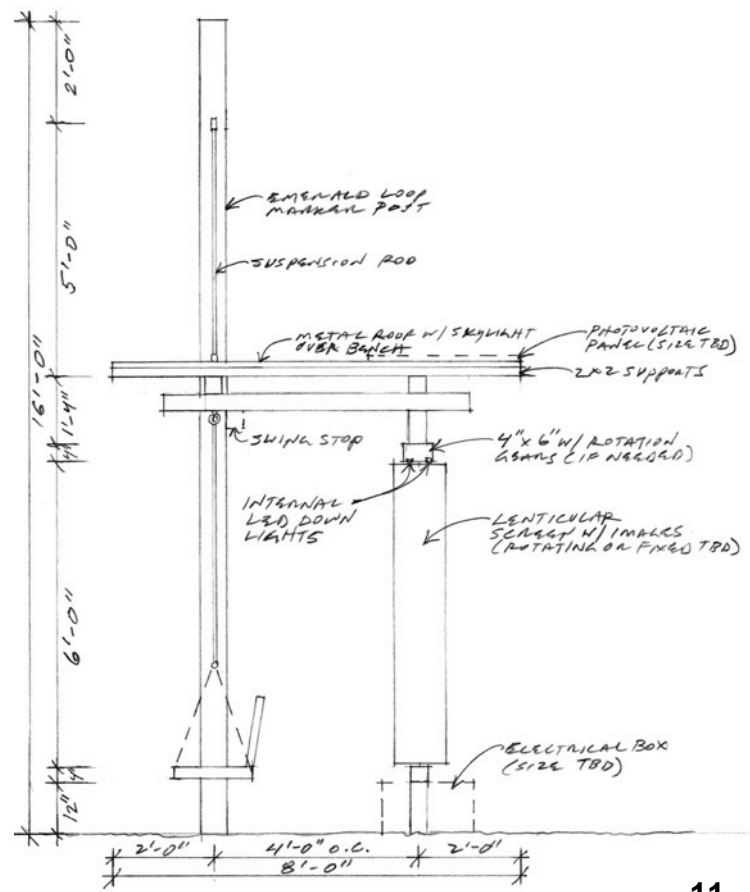

Side Elevation

Porch Swing



An off-the-shelf porch swing may be used

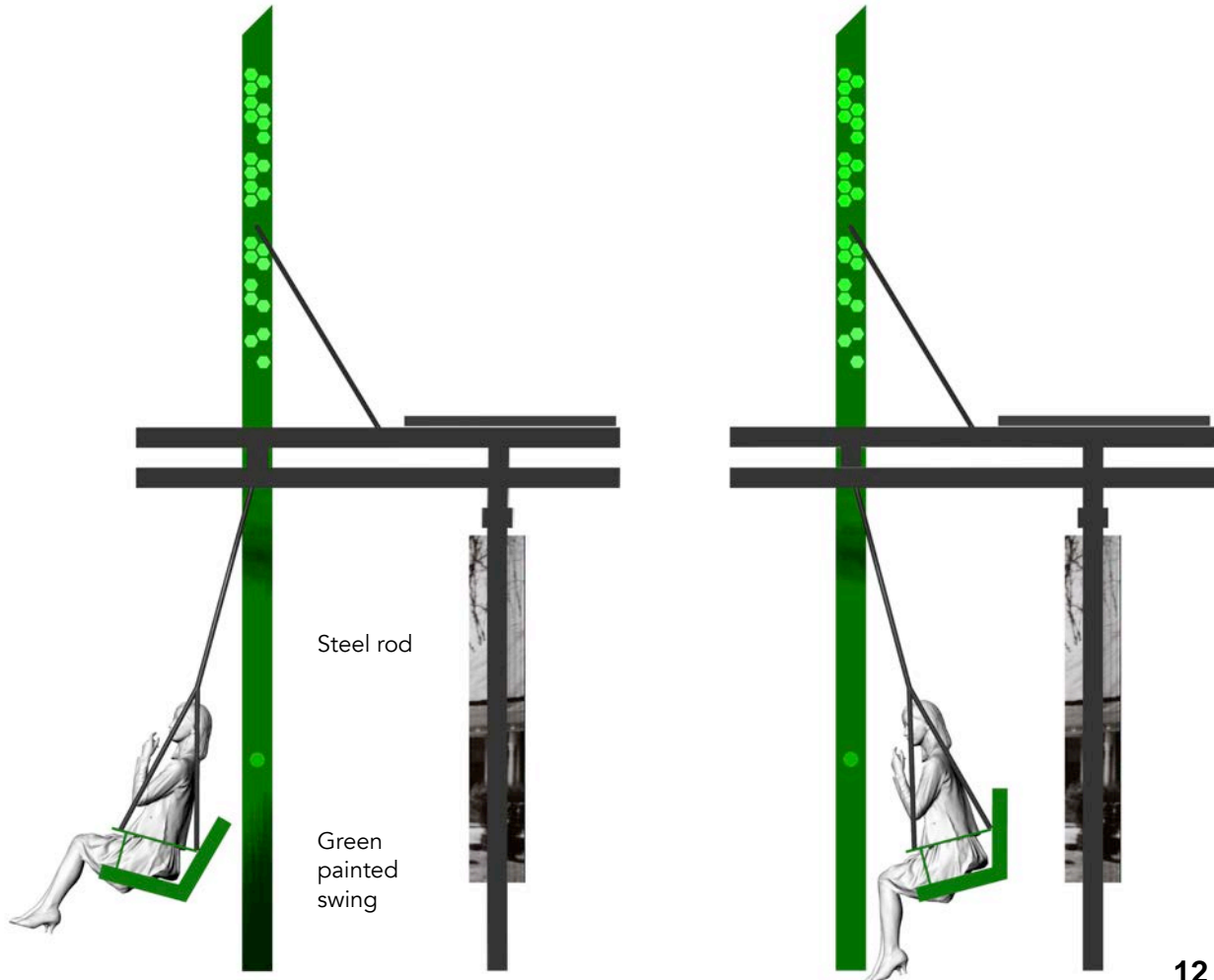

Steel stops in roof frame limit swing motion in both directions

Imagery for Lenticular Fins

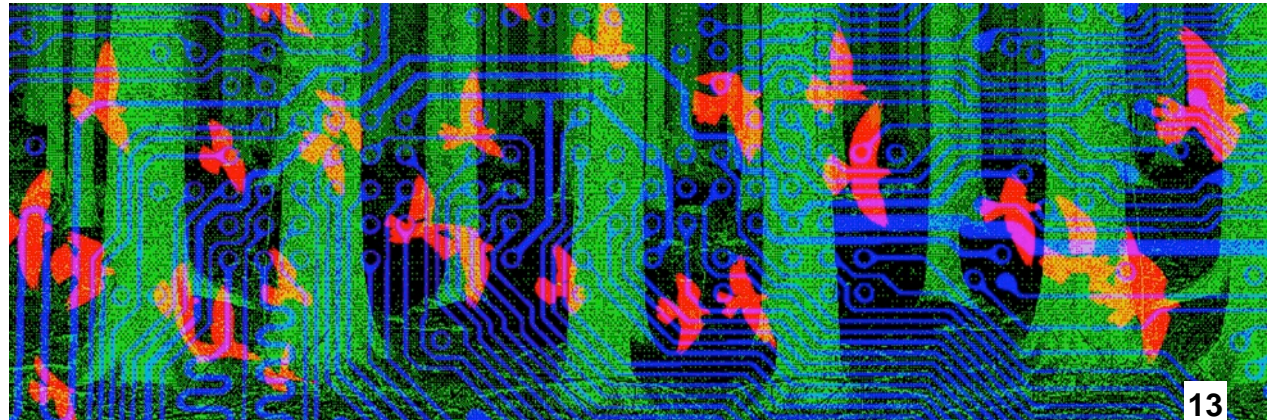
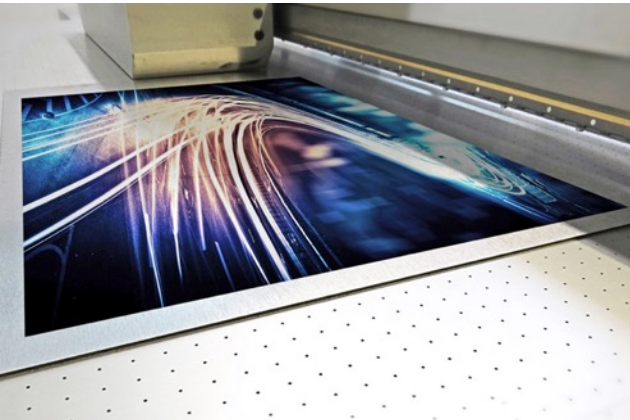

Lenticular Fins, Stationary (Perpendicular to Frame)



Right Side View

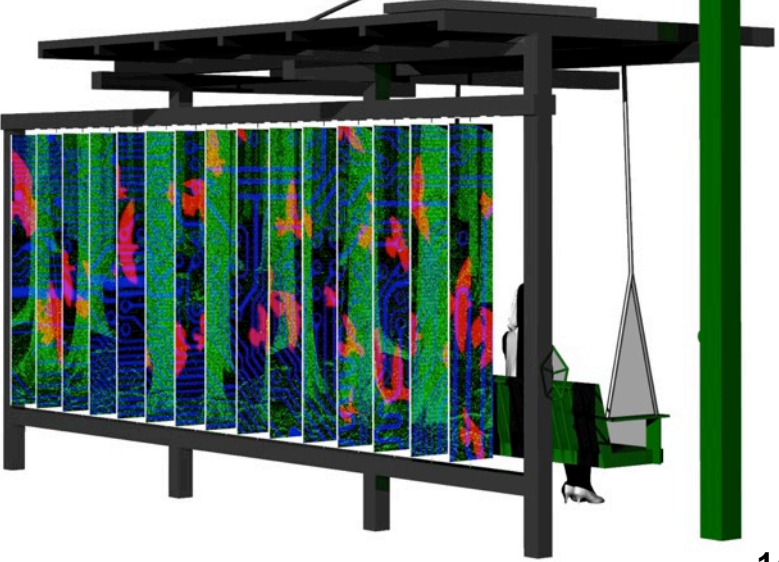

Left Side View

Lenticular Fins, Stationary

Rotation around shelter, GIF

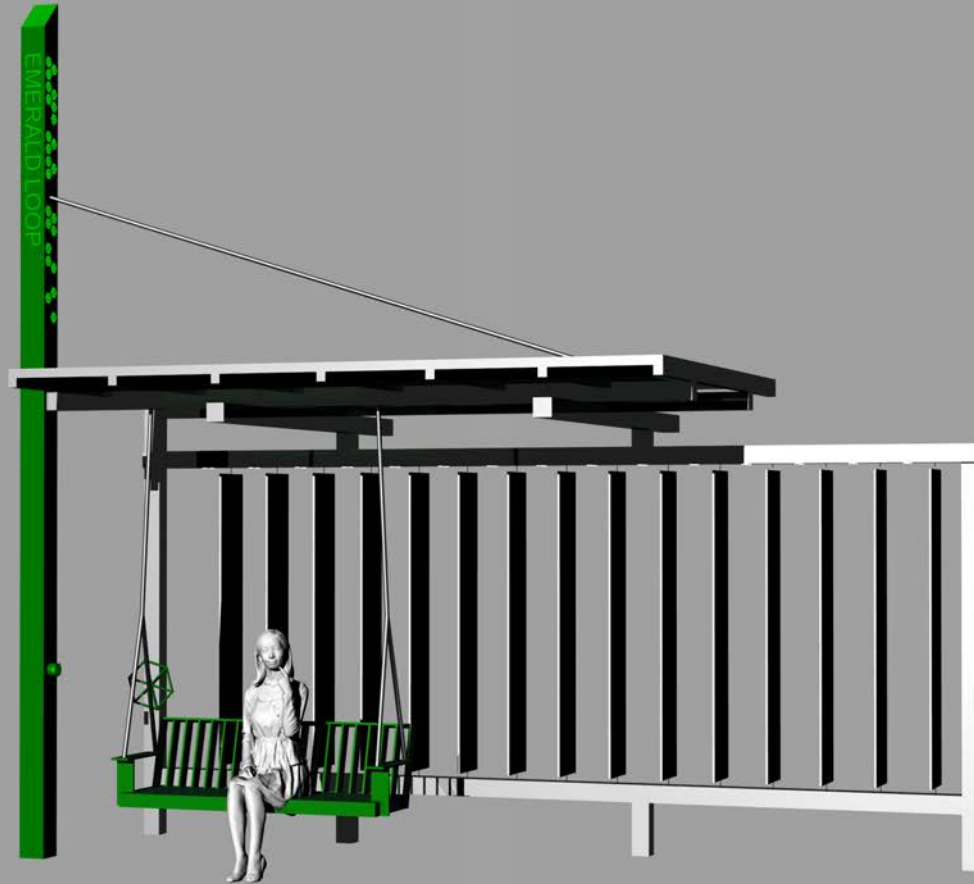

Lenticular Fins, Rotating



Sequence showing 180-degree rotation of fins

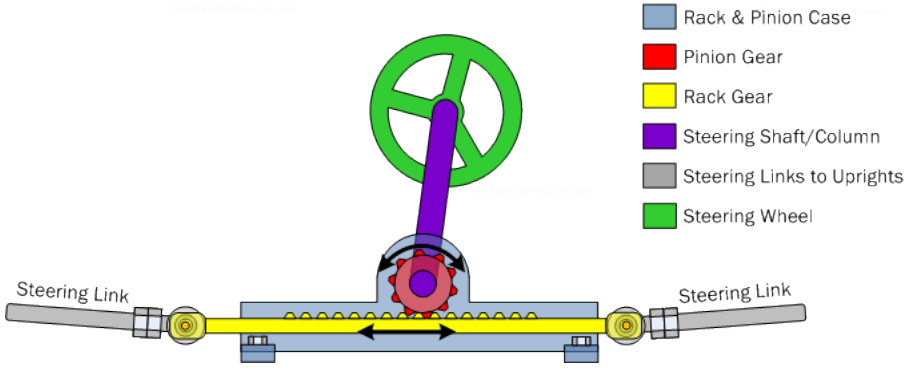

Rack and pinion gear system to be housed in horizontal steel tube along bottom of fins

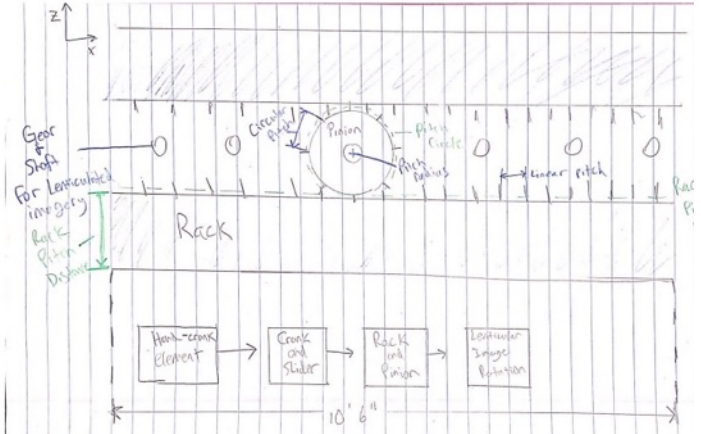

ECU student diagram of rack and pinion system

Lenticular Fins, Rotating

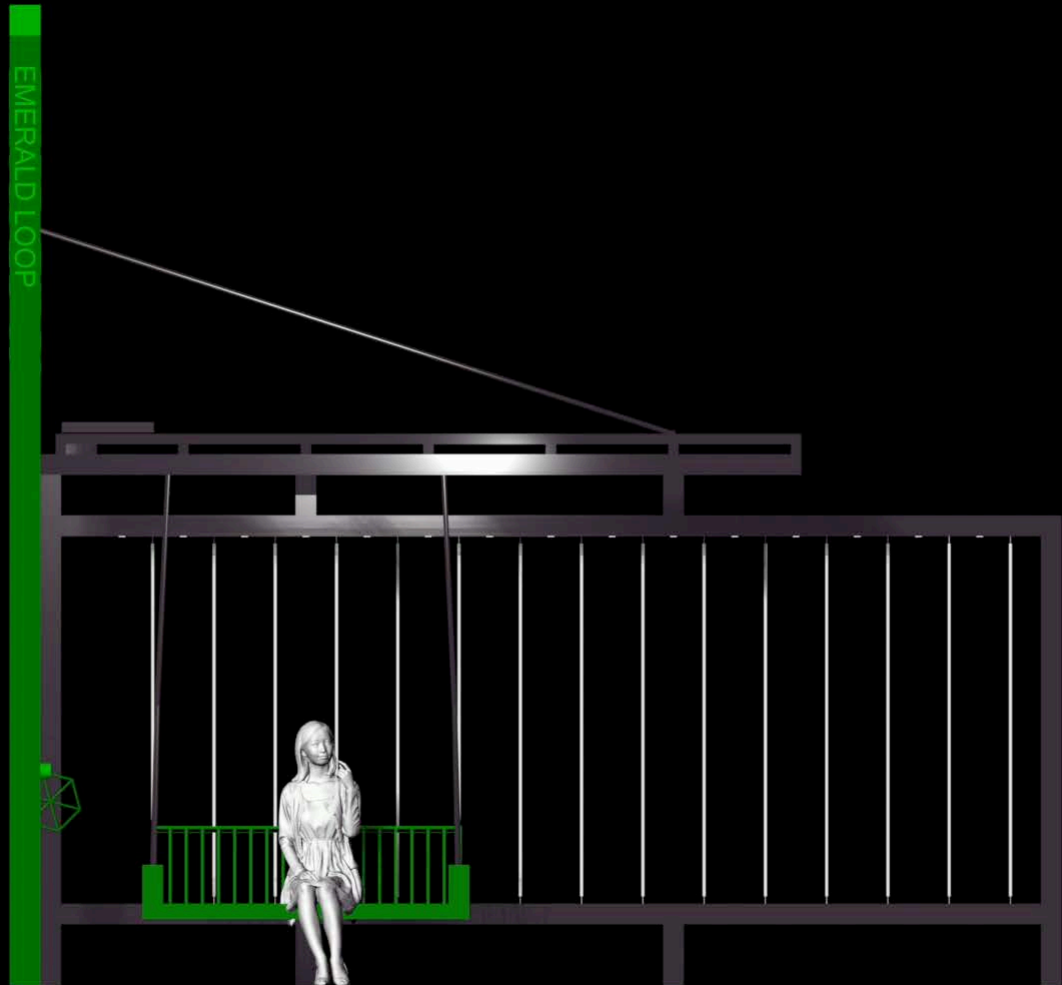

Rotation of lenticular fins, GIF

LED System



Stationary fins may require one LED betw

etween fins, to illuminate both sides i..

LEDs in Shelter Frame

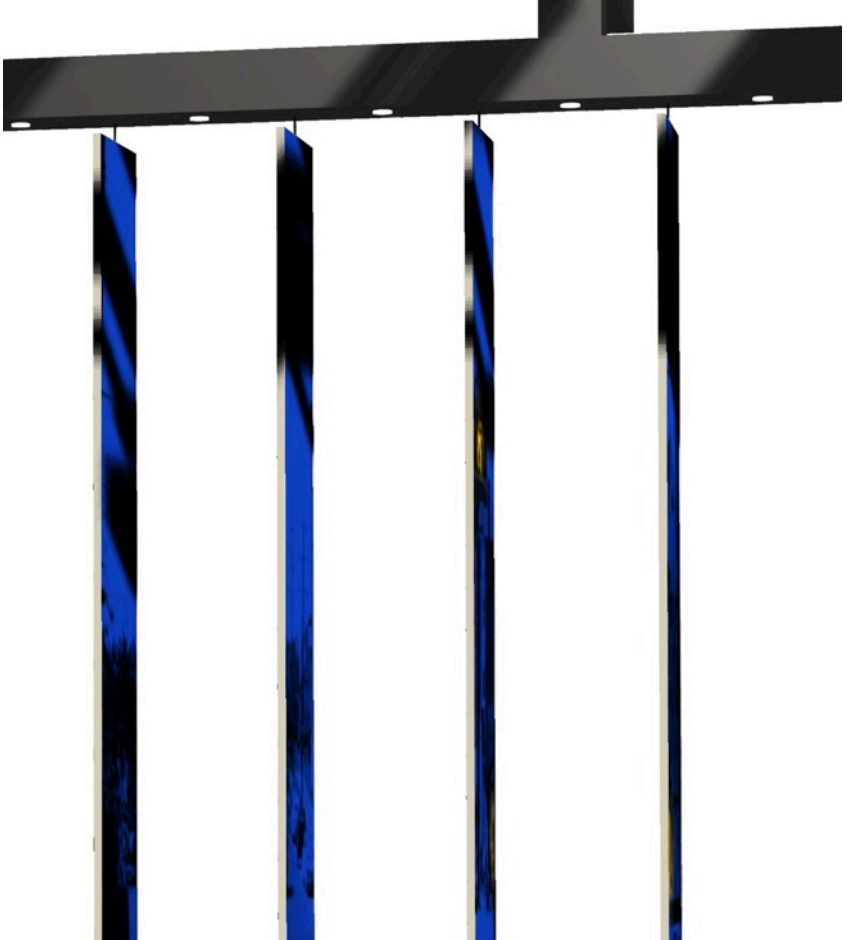

Stationary fins may require one LED between fins

Rotating fins require two LEDs between fins, to illuminate both sides i...
closed position

RGB Lighting Effects

Light colors changing on colored
historic photo of 1st Street,
video

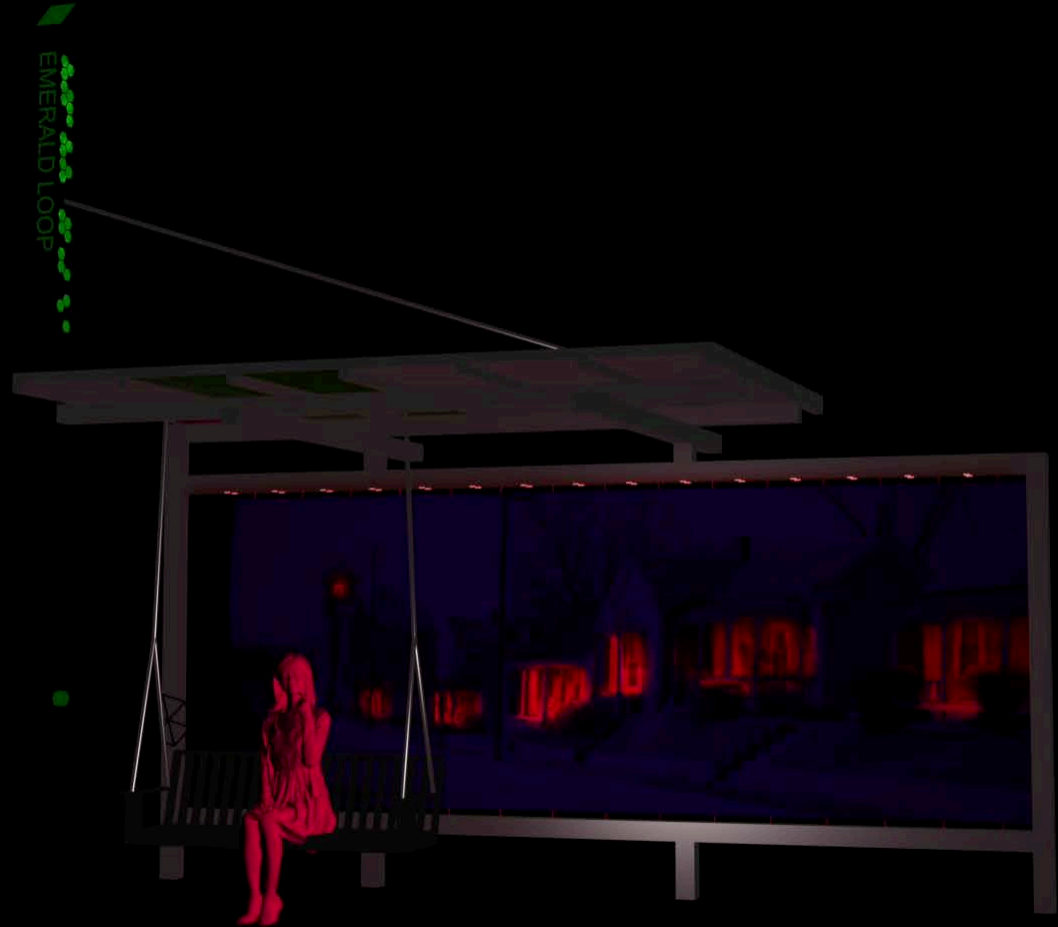

RGB Lighting Effects

Light colors changing on
placeholder RGB image, GIF

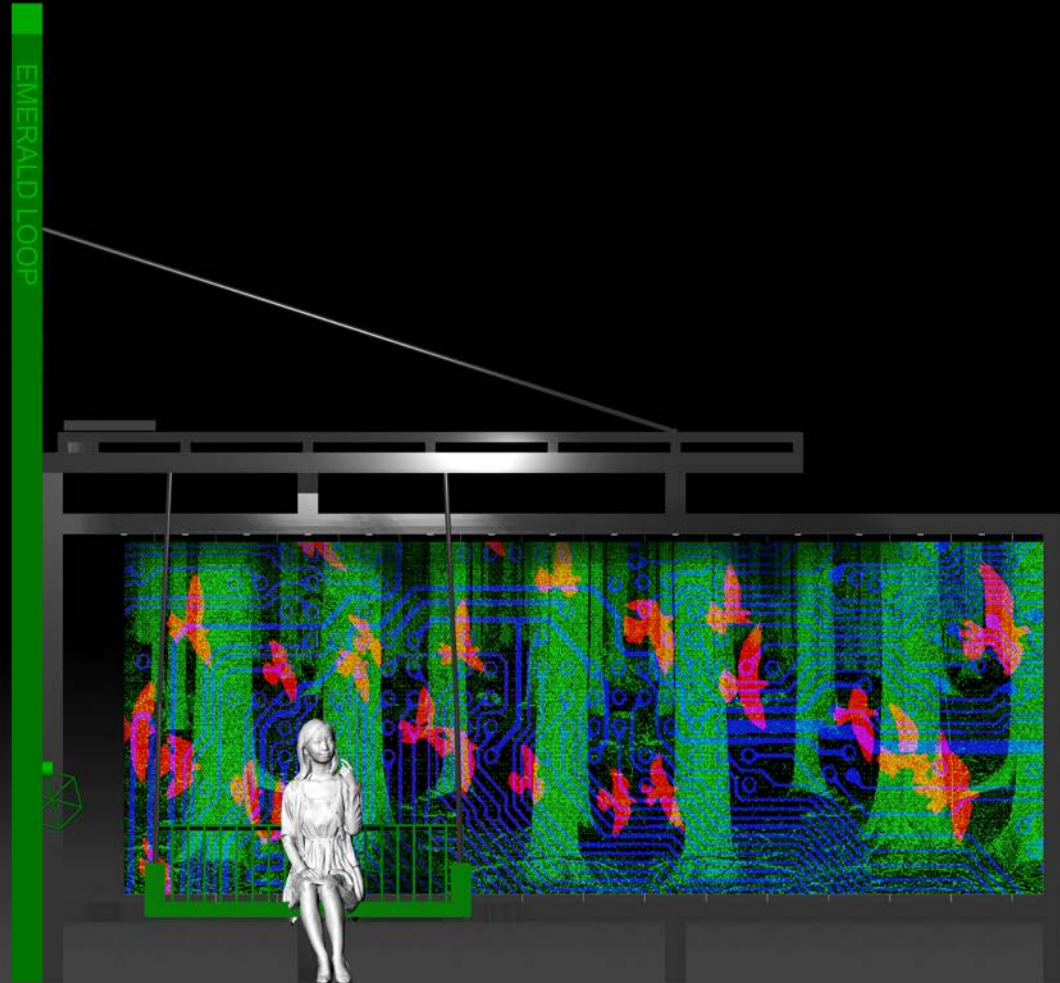

RGB Lighting Effects

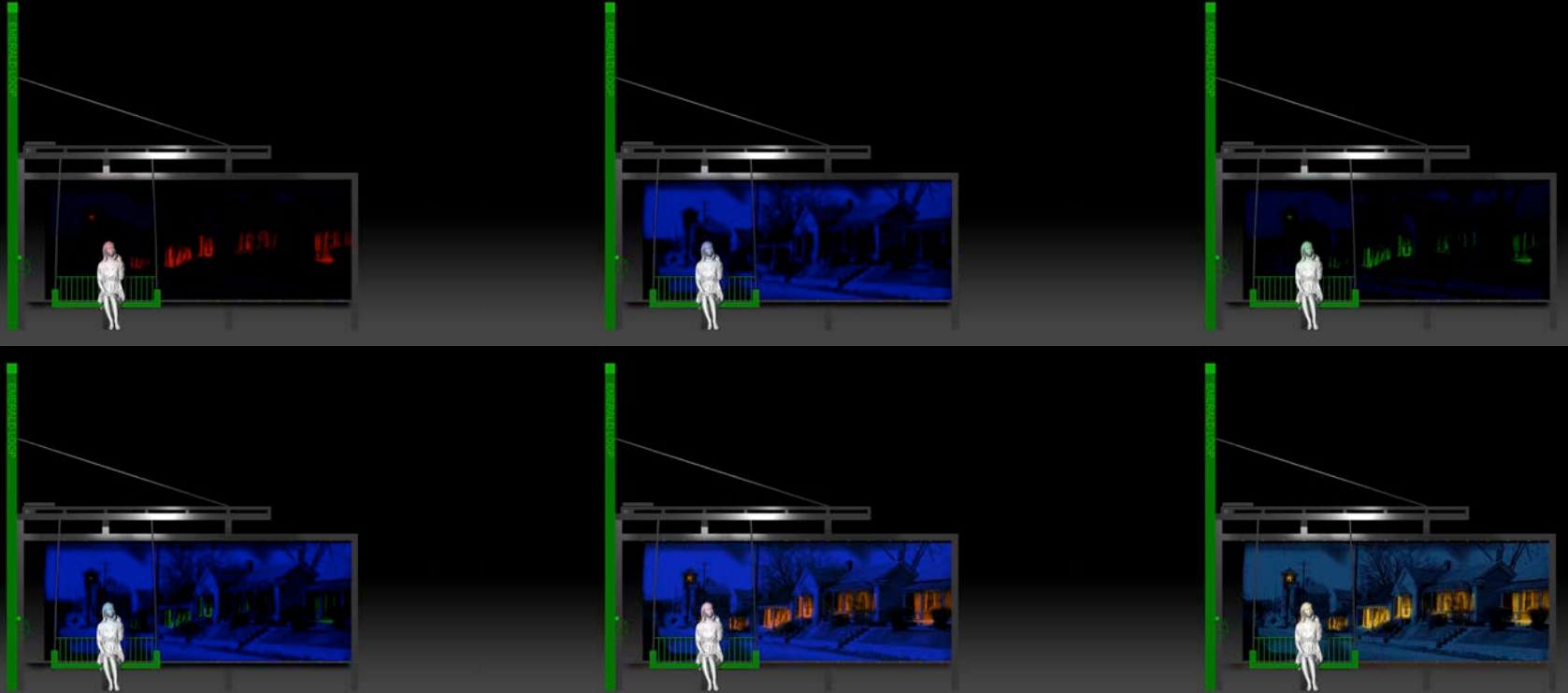

Light colors changing on historic 1st Street image

RGB Lighting Effects

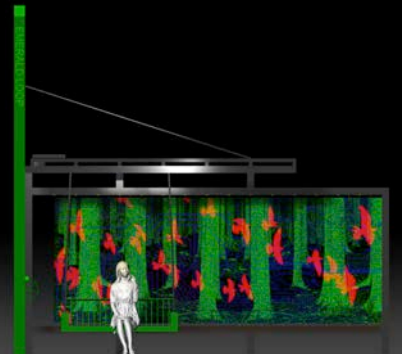
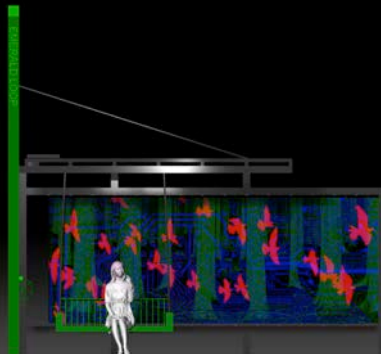
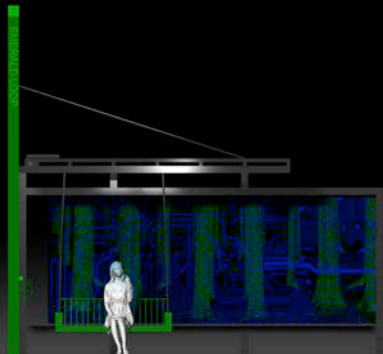
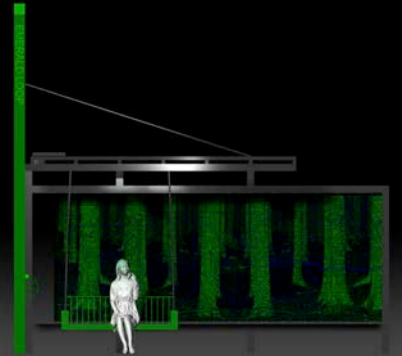
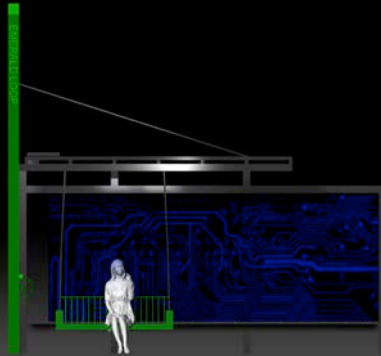

Light colors changing on placeholder RGB image



City of Greenville, North Carolina

Meeting Date: 10/10/2022

Title of Item: Discussion of Housing and Community Development Programs

Explanation: The Planning and Development Services Housing Division administers several federally funded programs intended to create and preserve affordable housing. Services are aimed, primarily, at benefiting low- and moderate-income citizens up to 80% of area median income (AMI). Occasionally, allowances are made to support households up to 120% AMI in an attempt to encourage mixed-income communities. Through Community Development Block Grant (CDBG), HOME Investment Partnership programs, and other State and local resources, staff administers the City's owner-occupied rehabilitation and energy efficiency programs, sub-recipient funds to non-profits, development of new construction for rent and ownership, down payment assistance, and other activities as resources and regulations allow.

Through the American Rescue Plan Act, the City was awarded an additional one-time HOME allocation specifically intended to address homelessness as a result of the pandemic. These HOME-ARP funds can be utilized for acquisition and construction of non-congregate shelter and supportive services for those who are experiencing or at risk of experiencing homelessness. The US Department of Housing and Urban Development (HUD) has detailed a specific engagement process required for determining the use of these funds in each community. The Allocation Plan, the plan for use and official request for funds is to be submitted to HUD following the citizen engagement period. Staff intends to present this draft plan to City Council in November.

Fiscal Note: CDBG annual allocation - \$975,355
HOME annual allocation - \$607,922
HOME-ARP one-time allocation - \$1,988,461

Recommendation: This item is for informational purposes only.



City of Greenville, North Carolina

Meeting Date: 10/10/2022

Title of Item: Presentation of the Integrated Mobility & Enhancement Plan (IMEP) for the Transit Division of the Public Works Department

Explanation: Greenville Area Transit (GREAT) of the Public Works Department has been working with AECOM Technical Services of North Carolina to develop an Integrated Mobility and Enhancement Plan (IMEP). The development of the plan focused on evaluating the current GREAT bus system and identifying areas for improvement and expansion of public transit in the City of Greenville.

The IMEP highlights the opportunity for GREAT to provide more efficient public transit with expanded access to passengers. The new system plan will enhance public transit service throughout the city with the following updates:

- Streamline the fixed bus route system for more efficient service and shorter lead times;
- Create new on-demand zones to supplement the fixed route system with scheduled pickups;
- Reduce wait times for passengers on buses and on-demand vehicles; and
- Introduce mobility hubs with waiting spaces (shelter/bench) and other amenities (bike racks, ticket vending, etc.).

Fiscal Note: The estimated annual cost for the revised fixed-route and on-demand service is cost neutral, meaning that the cost of the revised system is estimated to be equivalent to the FY 23 operating budget for the current fixed-route only system. Additional services, such as extended operating hours, weekend service and regional service areas (Winterville, Ayden, and Bethel) would, if implemented, each incur an additional annual cost.

Recommendation: City Council to consider the Integrated Mobility Enhancement Plan for the City of Greenville's GREAT System.
