

SITE INFORMATION	
TOTAL AREA IN SITE	11.4 ACRES
TOTAL AREA DISTURBED	4,000 SQ. FT.
CURRENT ZONING	IU
PARCEL NUMBER	05936
STREET ADDRESS	1500 Beatty Street
ACREAGE IN COMMON AREAS	NONE
ACREAGE IN RECREATION AREAS	NONE
TOTAL NUMBER OF NEW BUILDINGS	1
BUILDING LOT COVERAGE	N/A
TOTAL NUMBER OF NEW PARKING SPACES REQUIRED	0
TOTAL NUMBER OF NEW PARKING SPACES PROVIDED	0
TOTAL NUMBER OF NEW HANDICAP SPACES REQUIRED	1
TOTAL SQUARE FEET OF EXISTING IMPERVIOUS	300,000+ SQ. FT.
TOTAL SQUARE FEET OF NEW IMPERVIOUS	2,825 SQ. FT.



LEGEND

- IR = EXISTING IRON ROD
- RN = EXISTING NAIL
- X7=+45.00' - SPOT SHOT/ EXISTING GRADE
- X7=-45.00' - PROPOSED TOP OF FINISHED ELEVATION
- 3" = UNDERGROUND ELECTRICAL
- 3" = OVERHEAD ELECTRICAL

NOTES

- TOTAL DISTURBED AREA 4,000 SQUARE FEET. EROSION CONTROL PLAN NOT REQUIRED.
- LANDSCAPING IMPROVEMENTS NOT REQUIRED.
- STORMWATER MANAGEMENT PLAN NOT REQUIRED.
- DRIVEWAYS AND PARKING ARE EXISTING. NO ADDITIONAL PARKING IS REQUIRED.
- ALL IMPROVEMENTS SHALL CONFORM TO THE CITY OF GREENVILLE MANUAL OF STANDARD DESIGN AND DETAILS.
- CONTRACTOR MUST NOTIFY NC ONE CALL CENTER (811) OR (1-800-632-4949) A MINIMUM OF 48 HOURS PRIOR TO THE START OF ANY EXCAVATION ACTIVITIES TO HAVE UNDERGROUND UTILITIES LOCATED.
- CONTRACTOR TO NOTIFY PUBLIC WORKS STREET MAINTENANCE DIVISION 48 HOURS PRIOR TO MAKING ANY CONNECTIONS TO EXISTING PUBLIC STORM DRAIN SYSTEM.
- NO LANE CLOSURES ARE REQUIRED FOR THE DEVELOPMENT SHOWN HEREON.
- ALL AREAS CALCULATED BY COORDINATE GEOMETRY.
- ALL BEARINGS ARE RELATED TO NC GRID NORTH. ALL DISTANCES ARE GROUND MEASUREMENTS.
- PROPERTY IS NOT LOCATED IN A SPECIAL FLOOD HAZARD AREA AS DETERMINED BY THE FEDERAL EMERGENCY MANAGEMENT AGENCY. REF: FIRM 3720469700K, DATED JULY 7, 2014.
- ALL SITE LIGHTING SHALL CONFORM WITH THE LIGHTING STANDARDS FOR THE CITY OF GREENVILLE.
- NEW BUILDINGS MUST COMPLY WITH NC FIRE CODE SECTION 510 - EMERGENCY RESPONDER RADIO COVERAGE.

GRAPHIC SCALE

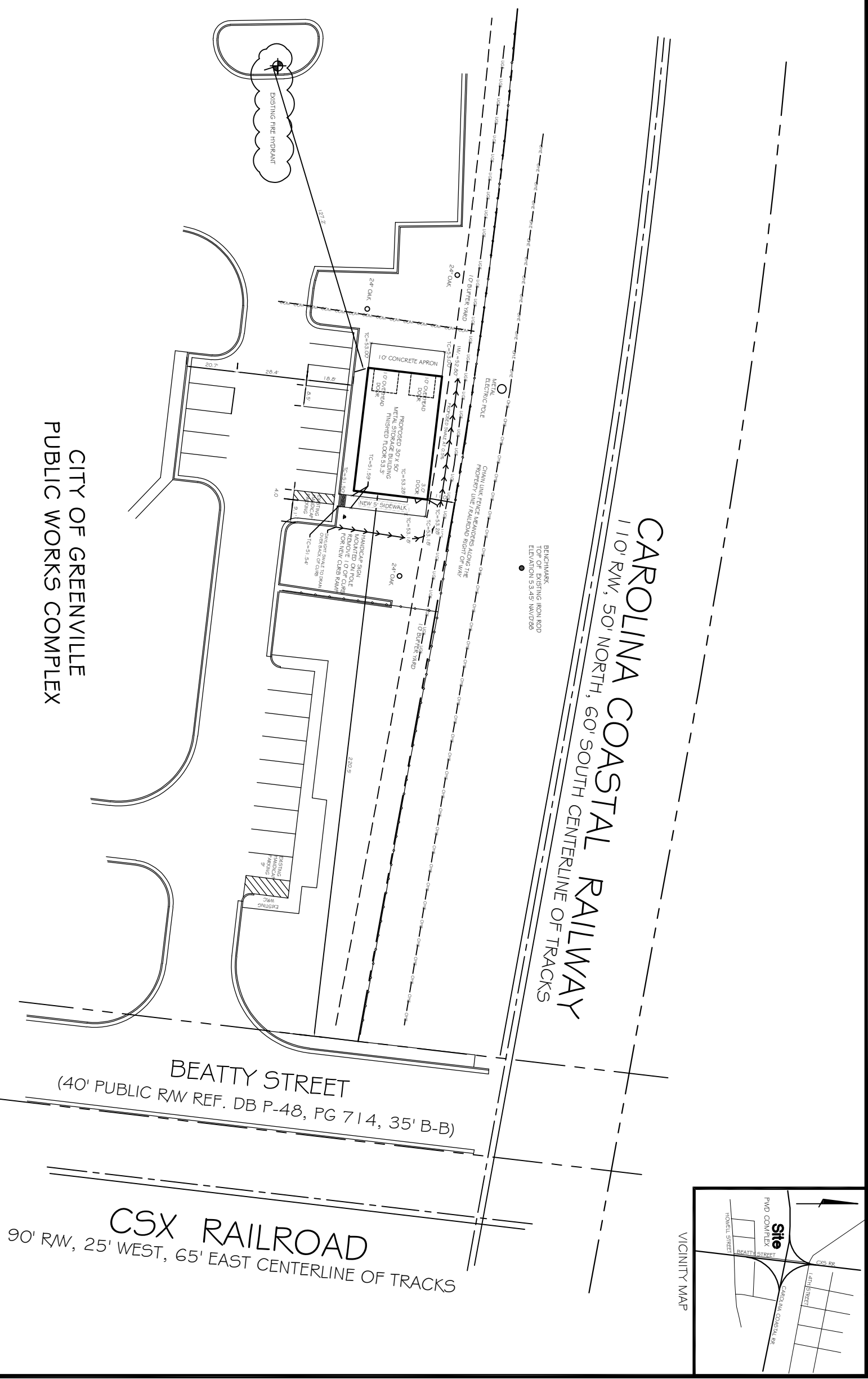

**CITY OF GREENVILLE
PUBLIC WORKS COMPLEX**

REVISIONS (6-20-23)

- ADD NOTE 13.
- ADD FIRE HYDRANT LOCATION.

FINAL DRAWING - NOT RELEASED FOR CONSTRUCTION

SHEET 1 OF 1

SURVEYOR'S CERTIFICATION

I, BILLY LEE NERILL, CERTIFY THAT THE BOUNDARY SURVEY, TOPOGRAPHICAL SURVEY, AND THE HORIZONTAL AND VERTICAL CONTROL WAS COMPLETED BY THE FOLLOWING ACTUAL SURVEY AND THE BOUNDARY SURVEY MADE BY ME. I DEED DESCRIPTION RECORDED IN BOOK MAP PAGE 372 OR BOOK MAP PAGE 372 AND THE BOUNDARY SURVEY MADE BY ME. I DEED DESCRIPTION RECORDED IN BOOK MAP PAGE 372 OR BOOK MAP PAGE 372. THE SURVEY WAS COMPLETED ON JUNE 5, 2023. THAT THE TOPOGRAPHIC DATA WAS OBTAINED ON JUNE 5, 2023. THAT THE SURVEY CONTROL WAS ESTABLISHED AT THE SITE TO THE CLASS 'X' STANDARD THAT A GLOBAL POSITIONING SYSTEM (GPS) SURVEY WAS PERFORMED TO POSITIONING ACCURACY STANDARDS, PART 2, STANDARDS FOR GEODETIC NETWORKS AT THE CLASS 'X' ACCURACY CLASSIFICATION (99% CONFIDENCE) AND THE FOLLOWING INFORMATION WAS USING TO PERFORM THE GPS SURVEY: DATE(S) OF SURVEY: JUNE 5, 2023. POSITIONAL ACCURACY: 0.05 Horiz. 0.08 Vert. TYPE OF GPS FIELD PROCEDURE: RTK NETWORK. DATE(S) OF SURVEY: JUNE 5, 2023. DATUM / EPOCH: NAD 83, NAD 2011. GEOID MODEL: GEOID 2012B.

SIGNED: PROFESSIONAL LAND SURVEYOR No. 12856

City of Greenville Site Plan Approval

Date:	Approved as Noted
Zoning	Engineering
Survey/Grading/Plan	Inspections
Fire/Rescue	GIS/ Electric
GIS/ Water/sewer	GIS/ Gas
NO/DO NOT	Vegetation
Traffic Services	Notes

PUBLIC WORKS STORAGE BUILDING

1500 BEATTY STREET, PARCEL NUMBER 05936 BEING THE PROPERTY RECORDED IN DEED BOOK M-47, PAGE 372 AND SHOWN ON A MAP RECORDED IN MAP BOOK 27, PAGE 55 GREENVILLE, GREENVILLE TOWNSHIP, WATAUGA COUNTY, NORTH CAROLINA
OWNER: CITY OF GREENVILLE
ADDRESS: PO BOX 7207, GREENVILLE, NC 27835
PHONE: 252-329-4467

	SUBMITTED: BIM	APPROVED: IK
NORTH CAROLINA	DRAWN: BIM	DATE: 05/09/23
1500 BEATTY STREET, PO BOX 7207, GREENVILLE, NC 27834	CHECKED: TW	SCALE: 1" = 20'

*Site plan approval ONLY. Engineer/Architect/Surveyor shall be responsible for all details in the plans. All plans shall meet all specifications, standards and applicable regulations.