

VICINITY MAP
SCALE NTS

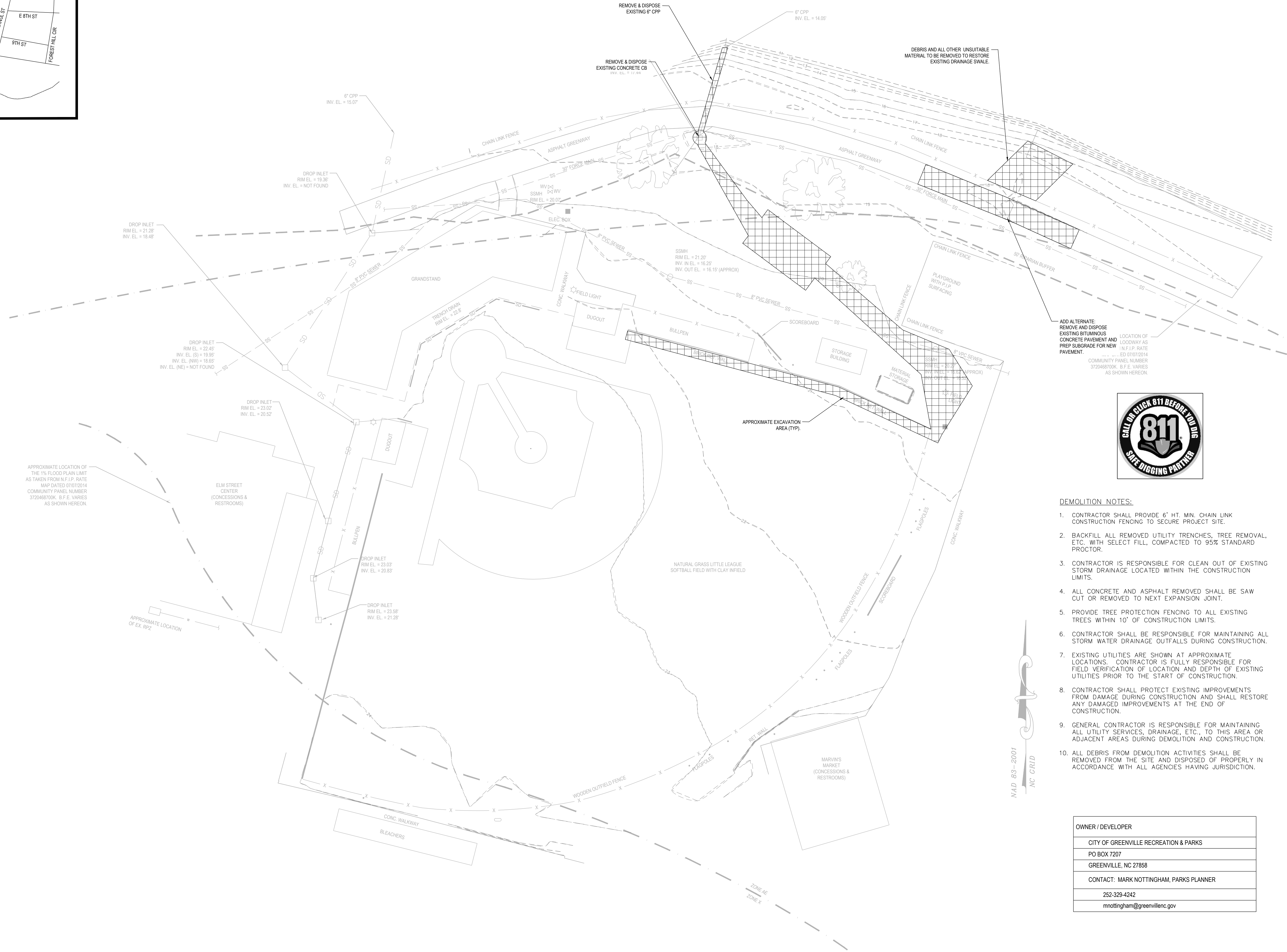

APPROXIMATE LOCATION OF THE 1% FLOOD PLAIN LIMIT AS TAKEN FROM N.F.I.P. RATE MAP DATED 07/07/2014. COMMUNITY PANEL NUMBER 3720468700K. B.F.E. VARIES AS SHOWN HEREON.

ELM STREET CENTER (CONCESSIONS & RESTROOMS)

MARVIN'S MARKET (CONCESSIONS & RESTROOMS)

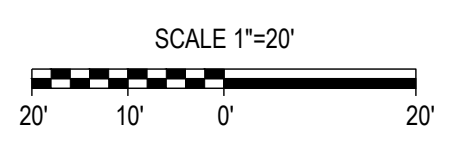

MAD 83-2001
NC CRID

THE EAST GROUP

- Engineering
- Architecture
- Surveying
- Technology

Corporate Office
324 Evans Street
Greenville, NC 27858
P: 252.758.3746
F: 252.830.3954

Branch Office
4325 Lake Boone Trail, Suite 311
Raleigh, NC 27607
P: 919.784.9330
F: 919.784.9331

NC Engineering Lic. No. C-0206
NC Architectural Lic. No. 60213
NC Landscape Architectural Lic. No. C-427



ADD ALTERNATE: REMOVE AND DISPOSE EXISTING BITUMINOUS CONCRETE PAVEMENT AND PREP SUBGRADE FOR NEW PAVEMENT.

LOCATION OF LODGWAY AS 1% F.I.P. RATE
ED 07/07/2014
COMMUNITY PANEL NUMBER 3720468700K. B.F.E. VARIES AS SHOWN HEREON.



DEMOLITION NOTES:

- CONTRACTOR SHALL PROVIDE 6' HT. MIN. CHAIN LINK CONSTRUCTION FENCING TO SECURE PROJECT SITE.
- BACKFILL ALL REMOVED UTILITY TRENCHES, TREE REMOVAL, ETC. WITH SELECT FILL, COMPACTED TO 95% STANDARD PROCTOR.
- CONTRACTOR IS RESPONSIBLE FOR CLEAN OUT OF EXISTING STORM DRAINAGE LOCATED WITHIN THE CONSTRUCTION LIMITS.
- ALL CONCRETE AND ASPHALT REMOVED SHALL BE SAW CUT OR REMOVED TO NEXT EXPANSION JOINT.
- PROVIDE TREE PROTECTION FENCING TO ALL EXISTING TREES WITHIN 10' OF CONSTRUCTION LIMITS.
- CONTRACTOR SHALL BE RESPONSIBLE FOR MAINTAINING ALL STORM WATER DRAINAGE OUTFALLS DURING CONSTRUCTION.
- EXISTING UTILITIES ARE SHOWN AT APPROXIMATE LOCATIONS. CONTRACTOR IS FULLY RESPONSIBLE FOR FIELD VERIFICATION OF LOCATION AND DEPTH OF EXISTING UTILITIES PRIOR TO THE START OF CONSTRUCTION.
- CONTRACTOR SHALL PROTECT EXISTING IMPROVEMENTS FROM DAMAGE DURING CONSTRUCTION AND SHALL RESTORE ANY DAMAGED IMPROVEMENTS AT THE END OF CONSTRUCTION.
- GENERAL CONTRACTOR IS RESPONSIBLE FOR MAINTAINING ALL UTILITY SERVICES, DRAINAGE, ETC., TO THIS AREA OR ADJACENT AREAS DURING DEMOLITION AND CONSTRUCTION.
- ALL DEBRIS FROM DEMOLITION ACTIVITIES SHALL BE REMOVED FROM THE SITE AND DISPOSED OF PROPERLY IN ACCORDANCE WITH ALL AGENCIES HAVING JURISDICTION.

OWNER / DEVELOPER	
CITY OF GREENVILLE RECREATION & PARKS	
PO BOX 7207	
GREENVILLE, NC 27858	
CONTACT: MARK NOTTINGHAM, PARKS PLANNER	
252-329-4242	
mnottingham@greenvillenc.gov	

REV#	DATE	DESCRIPTION	BY	CHK

TEG PROJECT NO. 20240091

CLIENT PROJECT NO.

PROJECT TITLE
**COG STALLING STADIUM
DRAINAGE IMPROVEMENTS**

1055 S ELM STREET
GREENVILLE, 27858
PITT COUNTY

SHEET NAME
**EXISTING CONDITIONS
AND DEMOLITION PLAN**

SHEET NO.
C0.1

K:\CADD\2024\091 COG Stalling Stadium Drainage\CD\CD\Project\PE\DWG\SHEET\SCM\Sheet\SCM20240091_C0.1_COMP.dwg

SEEDING AND MULCHING

ALL ROADWAY AREAS			
MAR 1 - AUG 31	50# TALL FESCUE	SEPT 1 - FEB 28	50# TALL FESCUE
10# CENTIPEDE	10# CENTIPEDE	35# BERMUDAGRASS (HULLED)	35# BERMUDAGRASS (HULLED)
500# FERTILIZER	500# FERTILIZER	4000# LIMESTONE	4000# LIMESTONE

WATER AND BORROW LOCATIONS			
MAR 1 - AUG 31	75# TALL FESCUE	SEPT 1 - FEB 28	75# TALL FESCUE
25# BERMUDAGRASS (HULLED)	35# BERMUDAGRASS (HULLED)	500# FERTILIZER	500# FERTILIZER
4000# LIMESTONE	4000# LIMESTONE		

NOTE: 50% OF BAHUAGRASS MAY BE SUBSTITUTED FOR EITHER CENTIPEDE OR BERMUDAGRASS ONLY UPON ENGINEER'S REQUEST.

TEMPORARY SEEDING

DATE		
APR 15-AUG 14	GERMAN MILLET	50 LBS/ACRE
AUG 15-APR 14	RYE (GRAIN)	50 LBS/ACRE
YEAR ROUND	FERTILIZER 10-10-10 ANALYSIS	400 LBS/ACRE

PERMANENT ORNAMENTAL PLANTING AND SOD:
SEE PLANTING PLAN (L3.1) FOR LAYOUT, NOTES,
DETAILS, AND SCHEDULE.

EROSION NOTES:

1. LAND DISTURBING ACTIVITIES SHALL NOT OCCUR BEFORE NOTIFYING THE CITY OF THE DATE OF LAND DISTURBING ACTIVITY, AND RECEIVING APPROVAL FROM THE CITY. NO LAND DISTURBING ACTIVITY BEYOND THAT REQUIRED TO INSTALL APPROPRIATE EROSION CONTROL MEASURES SHALL PROCEED UNTIL EROSION CONTROL MEASURES ARE INSPECTED AND APPROVED BY THE ENGINEER.
2. SEED, MULCH, OR OTHERWISE PROVIDE GROUND COVER DEVICES OR STRUCTURES SUFFICIENT TO RESTRAIN EROSION FOR ALL EXPOSED SLOPES WITHIN 14 WORKING DAYS OF COMPLETING ANY PHASE OF GRADING.
3. CONTRACTOR SHALL INSPECT AND MAINTAIN ALL EROSION CONTROL DEVICES, AS NEEDED, AS NOTED IN THE MAINTENANCE PLAN. FAILURE TO KEEP EROSION CONTROL DEVICES IN GOOD WORKING ORDER MAY RESULT IN AN ISSUANCE OF A STOP WORK ORDER OR CIVIL PENALTIES OF UP TO \$5,000 PER DAY OF VIOLATION.
4. PLEASE BE ADVISED OF THE RULES TO PROTECT AND MAINTAIN EXISTING BUFFERS ALONG WATERCOURSES IN THE NEUSE AND TAR RIVER BASINS. THESE RULES ARE ENFORCED BY THE DIVISION OF WATER QUALITY (DWQ). DIRECT ANY QUESTIONS ABOUT THE APPLICABILITY OF THESE RULES RELATED TO YOUR PROJECT TO THE REGIONAL WATER QUALITY SUPERVISOR, WASHINGTON REGIONAL OFFICE (252) 946-6481.
5. INSTALL INLET PROTECTION AROUND ALL CATCH BASINS, DROP INLETS OR INLET STRUCTURES WITHIN THE CONSTRUCTION/DISTURBED AREA.
6. CONTRACTOR SHALL PROVIDE MEASURES TO CLEAN ANY SOILS OR SEDIMENTS THAT ARE TRACKED, PLACED, OR FLOW ONTO EXISTING PAVEMENT AND IMPROVE THE SURFACES THAT ARE TO REMAIN.
7. THIS PROJECT DISTURBS LESS THAN ONE ACRE AND DOES NOT REQUIRE ANY EROSION & SEDIMENT CONTROL PERMIT. HOWEVER, CONSTRUCTION ACTIVITIES ARE TO BE CONDUCTED IN ACCORDANCE WITH THE SEDIMENTATION CONTROL RULES AS OUTLINED IN THE NC ADMINISTRATIVE CODE TITLE 15A, CHAPTER 4, WHICH REQUIRES ALL SEDIMENT TO BE CONTAINED ON SITE.

MAINTENANCE PLAN:

1. ALL EROSION AND SEDIMENT CONTROL PRACTICES WILL BE CHECKED FOR STABILITY AND SEPARATION FOLLOWING EVERY RAINFALL EVENT RESULTING IN 0.5" OR MORE OF RAINFALL OVER A 24-HOUR PERIOD. IN NO CASE SHALL THESE INSPECTIONS OCCUR LESS THAN ONCE A WEEK. ANY NEEDED REPAIRS WILL BE MADE IMMEDIATELY TO MAINTAIN ALL PRACTICES AS DESIGNED.
2. SEDIMENT WILL BE REMOVED FROM BEHIND THE SEDIMENTATION FENCE ONCE THE SEDIMENT REACHES A DEPTH OF 0.5 FT AT THE FENCE LINE. THE SEDIMENT FENCE WILL BE REPAIRED AS NECESSARY TO MAINTAIN A SEDIMENT BARRIER.
3. TEMPORARY GRAVEL CONSTRUCTION ENTRANCE/EXIT MUST BE INSPECTED PERIODICALLY. ONCE MUD BUILD UP IS EVIDENT, IT SHALL BE BLADED OFF AND NEW STONE SHALL BE ADDED TO STABILIZE THE CONSTRUCTION ENTRANCE AS NEEDED.
4. ALL SEEDED AREAS WILL BE FERTILIZED, RE-SEEDED AS NECESSARY AND MULCHED ACCORDING TO THE SPECIFICATIONS IN THE VEGETATION PLAN TO MAINTAIN A VIGOROUS, AND DENSE VEGETATIVE COVER.
5. INSPECT ALL INLET PROTECTION FOLLOWING ANY RAINFALL EVENT RESULTING IN MORE THAN 0.5" OF RAINFALL OVER A 24-HR PERIOD. IN NO CASE SHALL THESE INSPECTIONS OCCUR LESS THAN ONCE A WEEK. REPAIR INLET PROTECTION AS NEEDED AND REMOVE SEDIMENT FROM THE SEDIMENT POOL AREA WHEN THE VOLUME HAS REDUCED TO 50% OF THE ORIGINAL VOLUME.
6. REMOVE INLET SEDIMENT PROTECTION IF IT IS GREATER THAN 50% FULL OF SEDIMENT AND DEBRIS, OR AS DIRECTED BY THE ENGINEER. REPLACE FABRIC IF TORN OR PUNCTURED TO >0.5" DIAMETER.

GROUND STABILIZATION		
SITE AREA DESCRIPTION	STABILIZATION TIME FRAME	STABILIZATION TIME FRAME EXCEPTIONS
PERMETER DIKES, SWALES, DITCHES AND SLOPES	7 DAYS	NONE
HIGH QUALITY WATER (HOW) ZONES	7 DAYS	NONE
SLOPES STEEPER THAN 3:1	7 DAYS	IF SLOPES ARE 10' OR LESS IN LENGTH AND ARE NOT STEEPER THAN 2:1, 14 DAYS ARE ALLOWED.
SLOPES 3:1 OR FLATTER	14 DAYS	7 DAYS FOR SLOPES GREATER THAN 50 FEET IN LENGTH
ALL OTHER AREAS WITH SLOPES FLATTER THAN 4:1	14 DAYS	NONE (EXCEPT FOR PERIMETERS AND HOW ZONES)

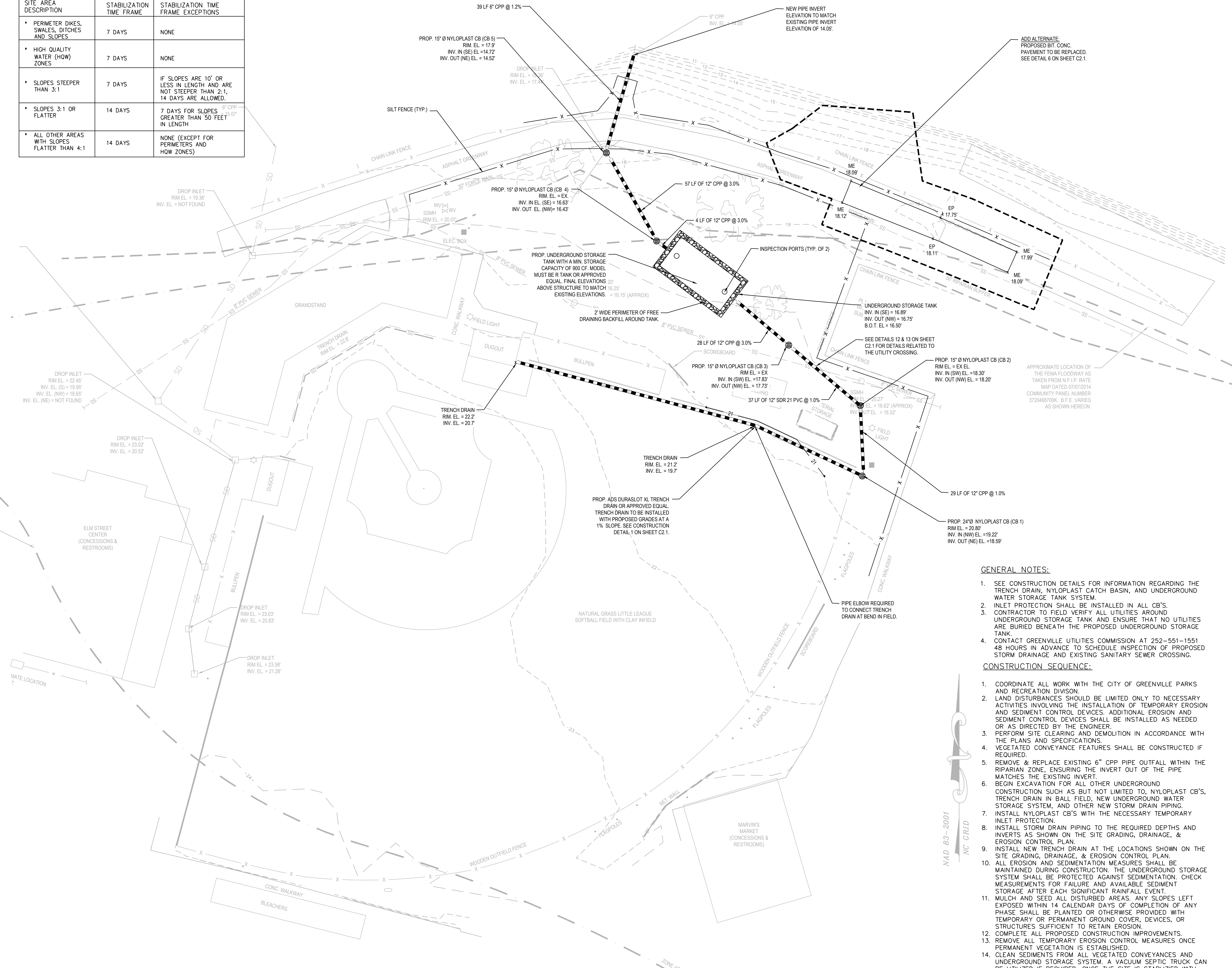

GENERAL NOTES:

1. SEE CONSTRUCTION DETAILS FOR INFORMATION REGARDING THE TRENCH DRAIN, NYLOPLAST CATCH BASIN, AND UNDERGROUND WATER STORAGE TANK SYSTEM.
2. INLET PROTECTION SHALL BE INSTALLED IN ALL CB'S.
3. CONTRACTOR TO FIELD VERIFY ALL UTILITIES AROUND UNDERGROUND STORAGE TANK AND ENSURE THAT NO UTILITIES ARE BURIED BENEATH THE PROPOSED UNDERGROUND STORAGE TANK.
4. CONTACT GREENVILLE UTILITIES COMMISSION AT 252-551-1551 48 HOURS IN ADVANCE TO SCHEDULE INSPECTION OF PROPOSED STORM DRAINAGE AND EXISTING SANITARY SEWER CROSSING.

CONSTRUCTION SEQUENCE:

1. COORDINATE ALL WORK WITH THE CITY OF GREENVILLE PARKS AND RECREATION DIVISION.
2. LAND DISTURBANCES SHOULD BE LIMITED ONLY TO NECESSARY ACTIVITIES INVOLVING THE INSTALLATION OF TEMPORARY EROSION AND SEDIMENT CONTROL DEVICES. ADDITIONAL EROSION AND SEDIMENT CONTROL DEVICES SHALL BE INSTALLED AS NEEDED OR AS DIRECTED BY THE ENGINEER.
3. PERFORM SITE CLEARING AND DEMOLITION IN ACCORDANCE WITH THE PLANS AND SPECIFICATIONS.
4. VEGETATED CONVEYANCE FEATURES SHALL BE CONSTRUCTED IF REQUIRED.
5. REMOVE & REPLACE EXISTING 6" CPP PIPE OUTFALL WITHIN THE RIPARIAN ZONE, ENSURING THE INVERT OUT OF THE PIPE MATCHES THE EXISTING INVERT.
6. BEFORE EXCAVATION FOR ALL OTHER UNDERGROUND CONSTRUCTION SUCH AS BUT NOT LIMITED TO, NYLOPLAST CB'S, TRENCH DRAIN IN BALL FIELD, NEW UNDERGROUND WATER STORAGE SYSTEM, AND OTHER NEW STORM DRAIN PIPING.
7. INSTALL NYLOPLAST CB'S WITH THE NECESSARY TEMPORARY INLET PROTECTION.
8. INSTALL STORM DRAIN PIPING TO THE REQUIRED DEPTHS AND INVERTS AS SHOWN ON THE SITE GRADING, DRAINAGE, & EROSION CONTROL PLAN.
9. INSTALL NEW TRENCH DRAIN AT THE LOCATIONS SHOWN ON THE SITE GRADING, DRAINAGE, & EROSION CONTROL PLAN.
10. ALL EROSION AND SEDIMENTATION MEASURES SHALL BE MAINTAINED DURING CONSTRUCTION. THE UNDERGROUND STORAGE SYSTEM SHALL BE PROTECTED AGAINST SEDIMENTATION. CHECK MEASUREMENTS FOR FAILURE AND AVAILABLE SEDIMENT STORAGE AFTER EACH SIGNIFICANT RAINFALL EVENT.
11. MULCH AND SEED ALL DISTURBED AREAS. ANY SLOPES LEFT EXPOSED WITHIN 14 CALENDAR DAYS OF COMPLETION OF ANY PHASE SHALL BE PLANTED OR OTHERWISE PROVIDED WITH TEMPORARY OR PERMANENT GROUND COVER, DEVICES, OR STRUCTURES SUFFICIENT TO RETAIN EROSION.
12. COMPLETE ALL PROPOSED CONSTRUCTION IMPROVEMENTS.
13. REMOVE ALL TEMPORARY EROSION CONTROL MEASURES ONCE PERMANENT VEGETATION IS ESTABLISHED.
14. CLEAN SEDIMENTS FROM ALL VEGETATED CONVEYANCES AND UNDERGROUND STORAGE SYSTEM. A VACUUM SEPTIC TRUCK CAN BE UTILIZED IF REQUIRED, ONCE THE SITE IS STABILIZED WITH ESTABLISHED VEGETATION.
15. TIME OF EXPOSURE IS APPROXIMATELY 2 MONTHS OR UNTIL PROJECT COMPLETION AND STABILIZATION OF THE SITE. CONTRACTOR SHALL TAKE ALL NECESSARY MEASURES TO PREPARE FOR MAINTENANCE AND STABILIZATION OF THE SITE AND MAINTAIN EROSION & SEDIMENTATION MEASURES APPROPRIATE FOR THE EXPECTED DURATION.

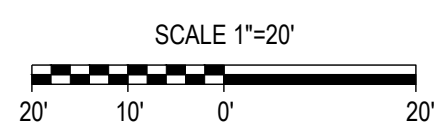

Engineering | Architecture
Surveying | Technology

Corporate Office
324 Evans Street
Greenville, NC 27858
P: 252.758.3746
F: 252.830.3954

Branch Office
4325 Lake Boone Trail, Suite 311
Raleigh, NC 27607
P: 919.784.9330
F: 919.784.9331

NC Engineering Lic. No. C-0206
NC Architectural Lic. No. 60213
NC Landscape Architectural Lic. No. C-427



CHK	DATE	DESCRIPTION

REV#	DATE	DESCRIPTION

TEG PROJECT NO. 20240091

CLIENT PROJECT NO.

PROJECT TITLE
**COG STALLING STADIUM
DRAINAGE IMPROVEMENTS**
1655 S ELM STREET
GREENVILLE, 27858
PITT COUNTY

SHEET NAME
**SITE GRADING, DRAINAGE, &
EROSION CONTROL PLAN**

SHEET NO.
C1.1

K:\CADD\2024\COG Stalling Stadium Drainage\COG Stalling Stadium Drainage\DWG\DRAINAGE\DRAINAGE_SHEET_C1.dwg

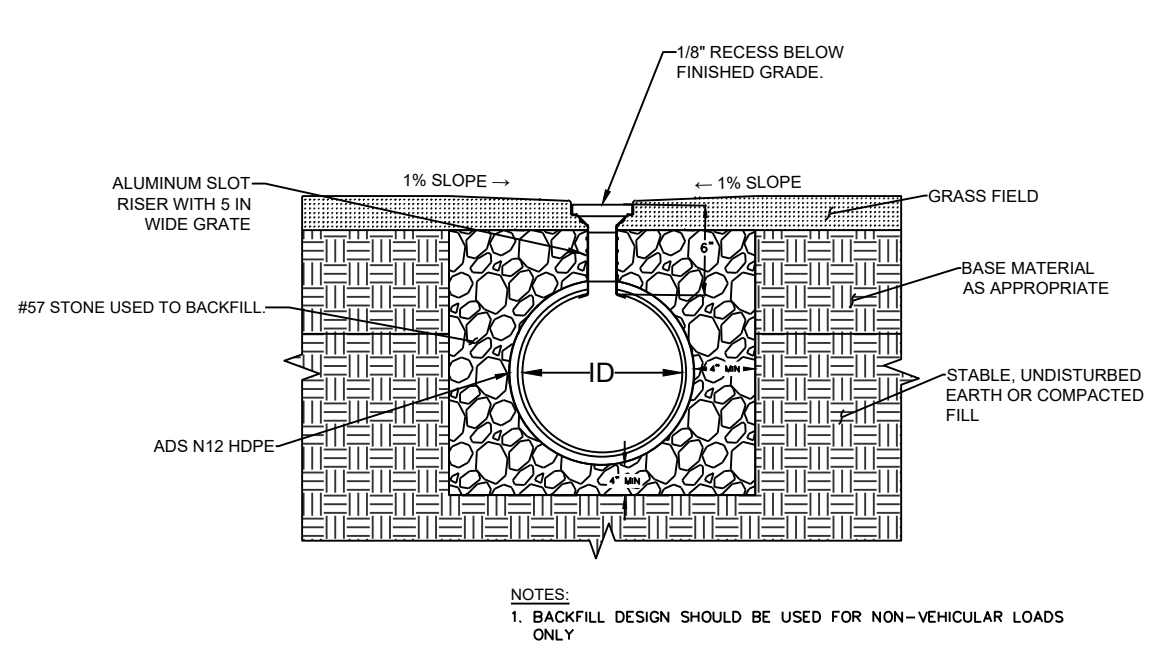

1 TRENCH DRAIN DETAIL
C2.1 KLS

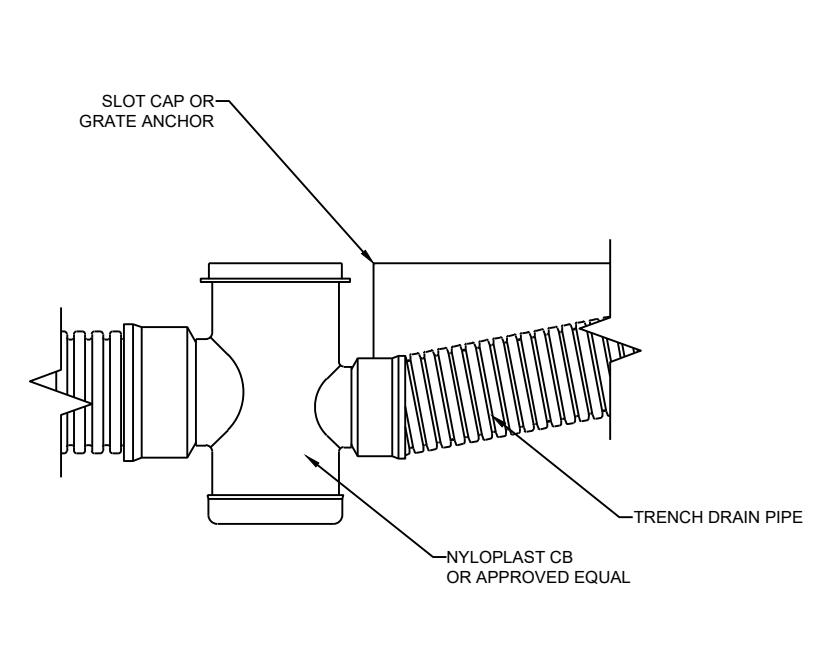

2 TRENCH DRAIN PIPING CONNECTION DETAIL
C2.1 KLS

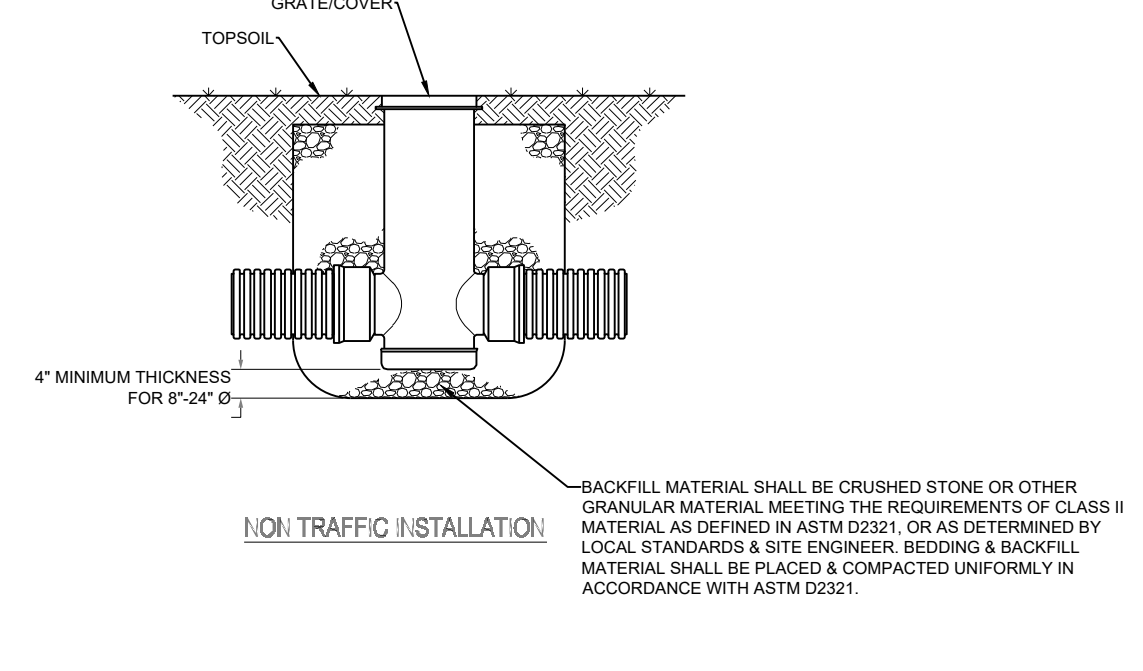

3 NYLOPLAST CB DETAIL
C2.1 KLS

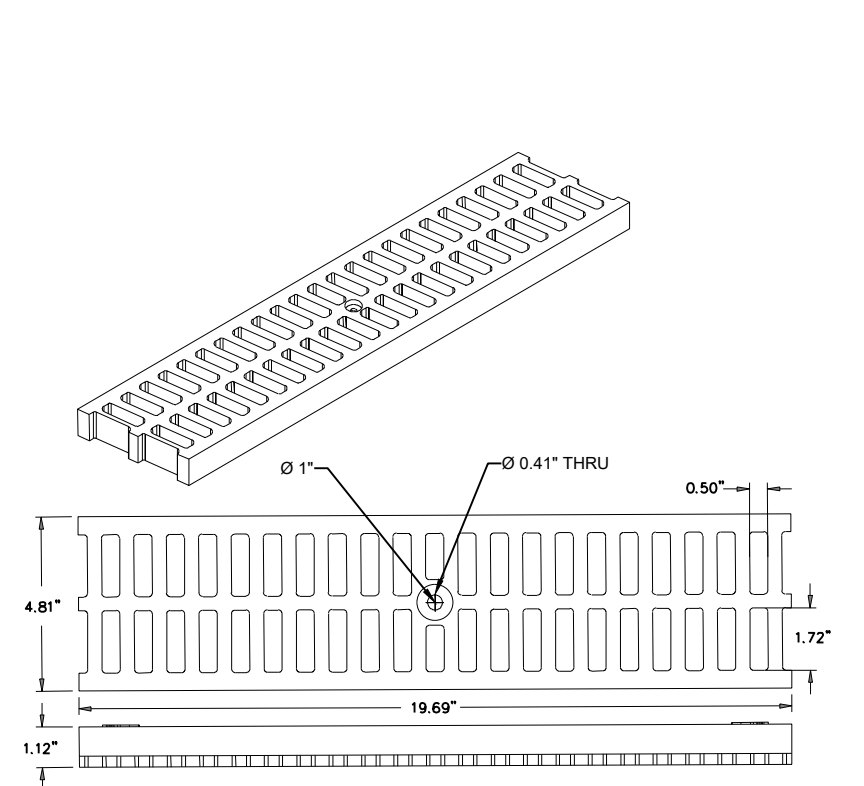

4 TRENCH DRAIN GRATE DETAIL
C2.1 KLS

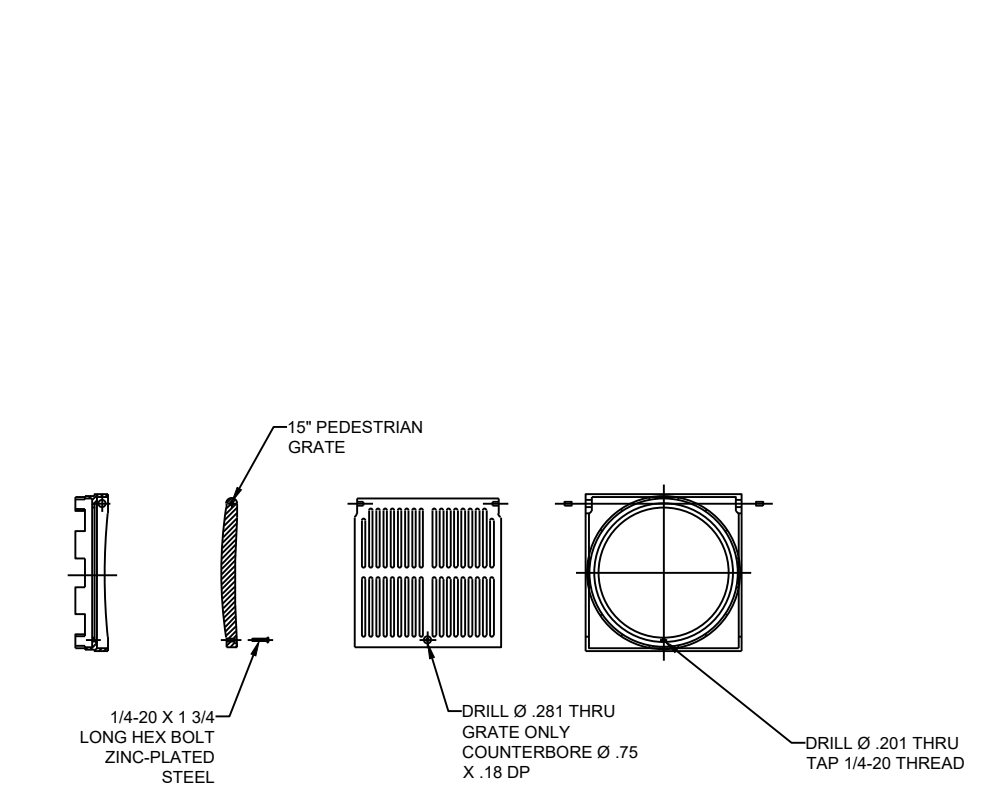

5 NYLOPLAST CB FRAME & GRATE DETAIL
C2.1 KLS

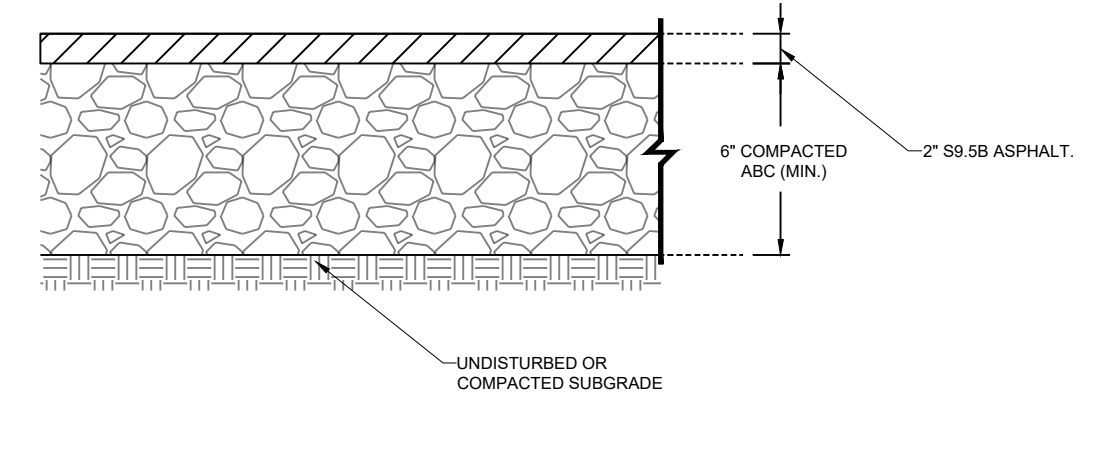

6 BIT CONC. PAVEMENT DETAIL
C2.1 KLS

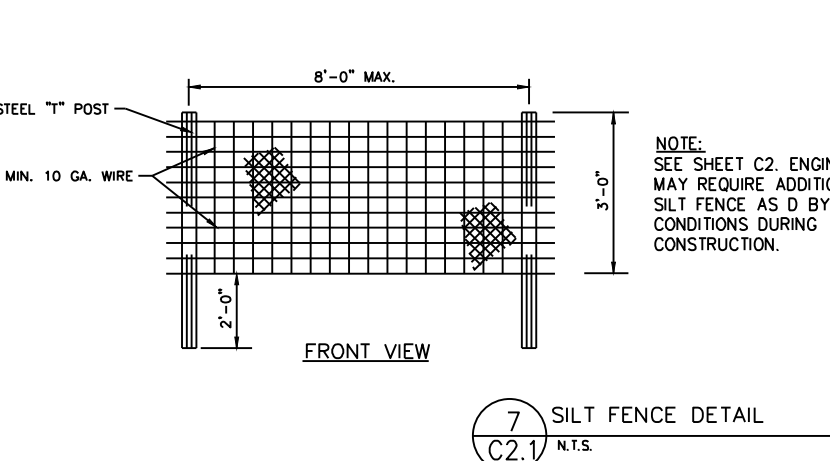

7 SILT FENCE DETAIL
C2.1 KLS

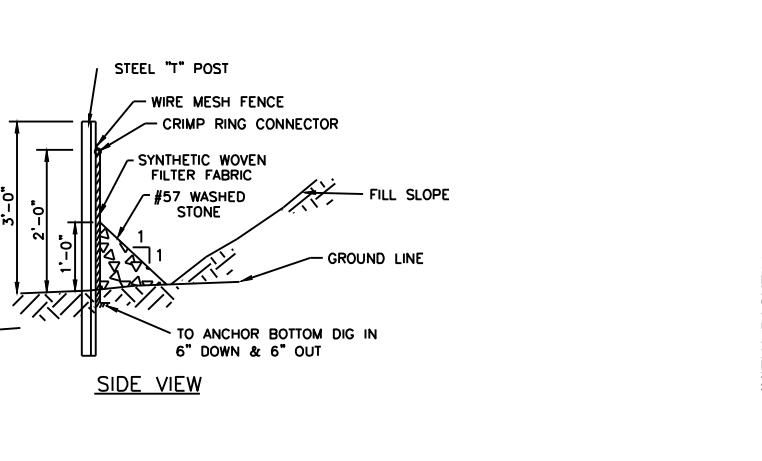

8 STORM DRAIN TRENCH DETAIL
C2.1 KLS

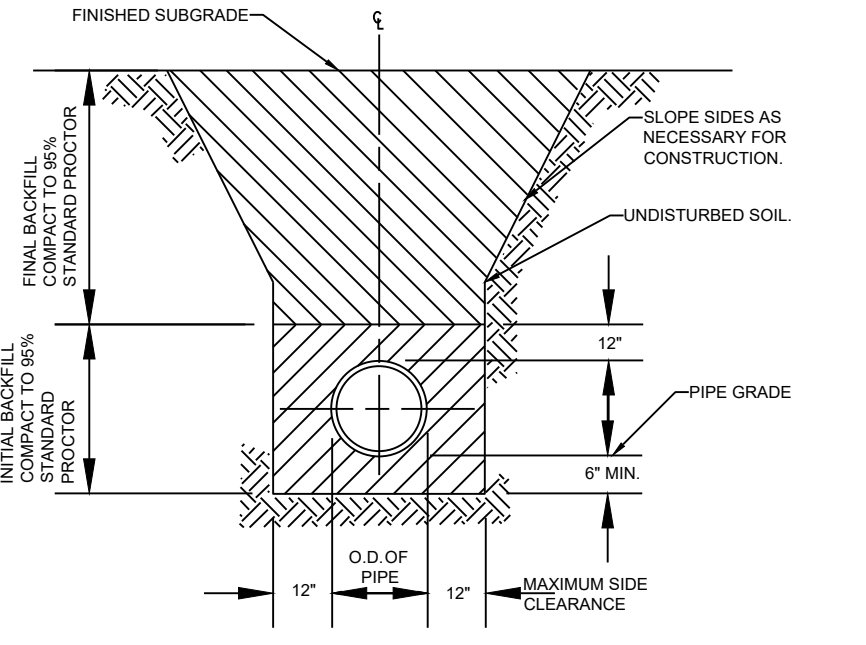

9 UNDERGROUND STORAGE TANK DETAIL
C2.1 KLS

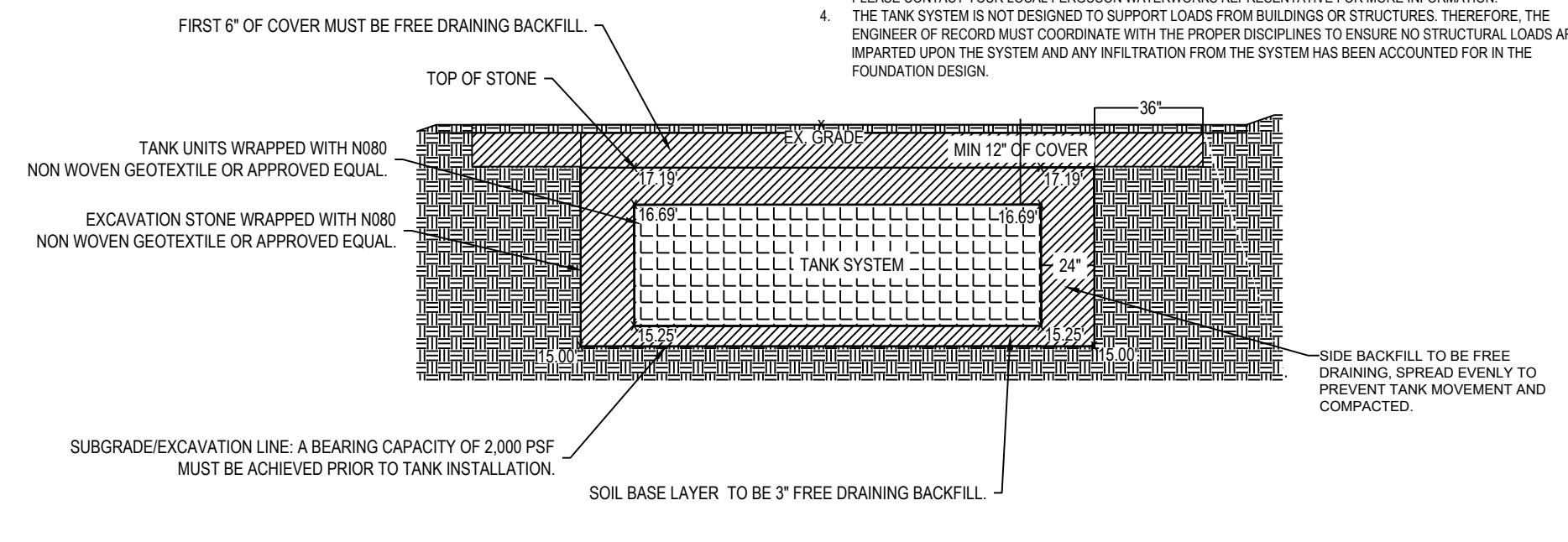

10 INLET PROTECTION DETAIL
C2.1 KLS

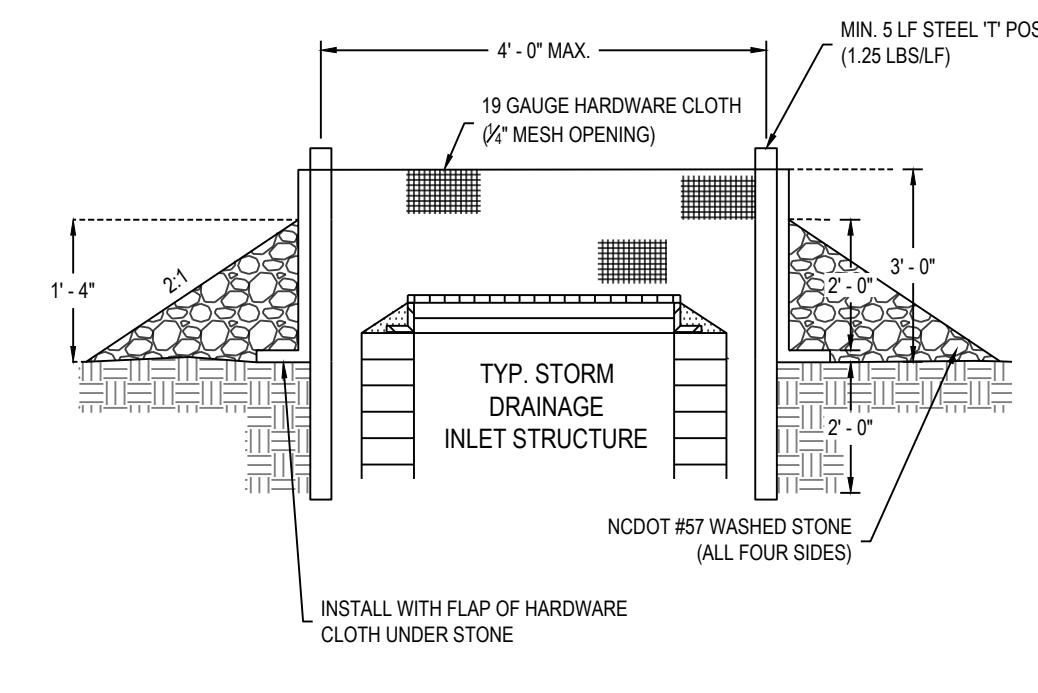

11 INSPECTION PORT DETAIL
C2.1 KLS

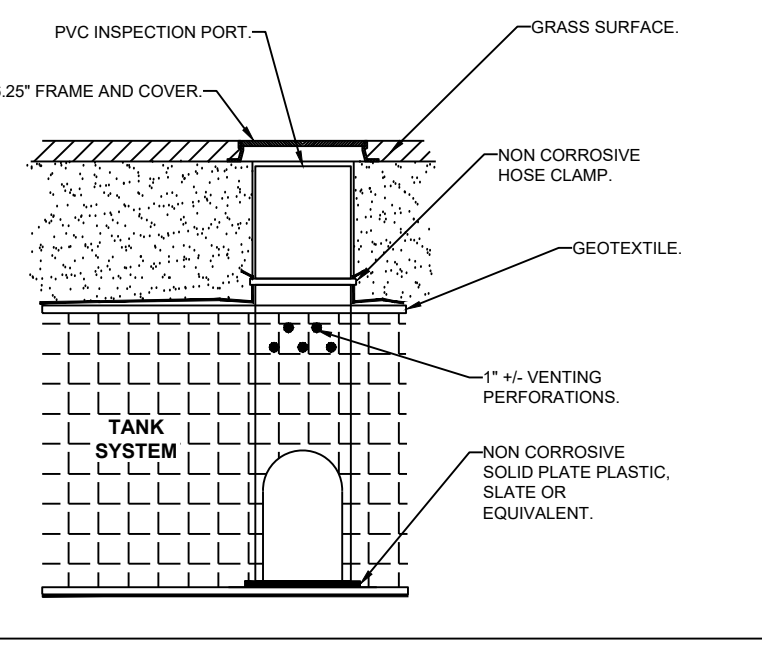

12 PROFILE VIEW OF STORM SEWER AT EXISTING SANITARY SEWER
C2.1 KLS

NOTE: WHEN A SANITARY SEWER MUST BE INSTALLED UNDER A STORM SEWER AND 12" OF VERTICAL SEPARATION CANNOT BE OBTAINED, SUPPORTS SHALL BE PROVIDED FOR THE STORM SEWER.

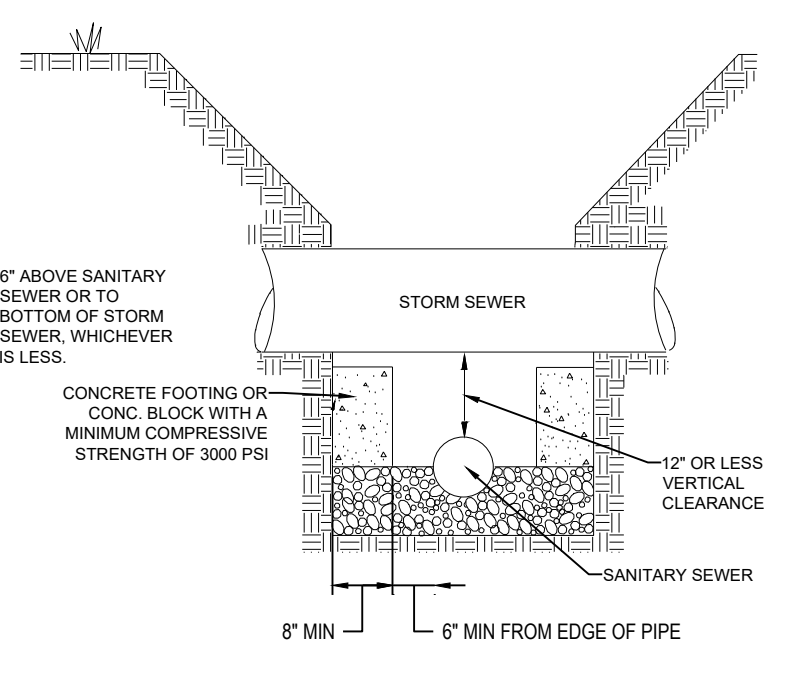

13 STORM SEWER CROSSING AT SANITARY SEWER DETAIL
C2.1 KLS

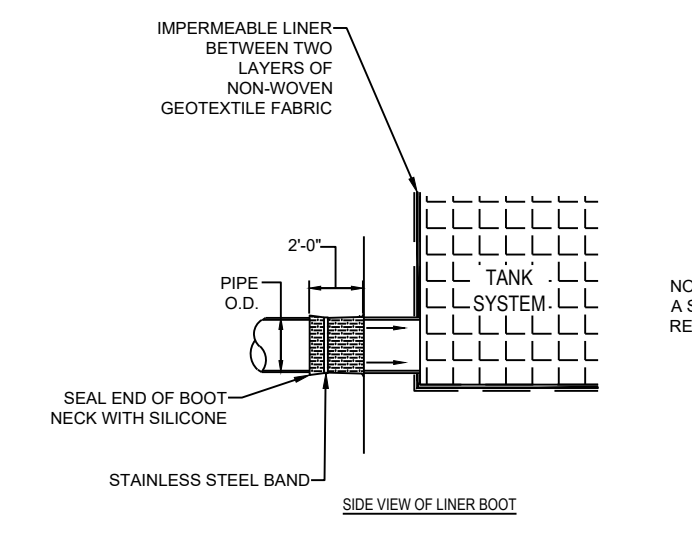

14 TANK INLET/OUTLET PIPE BOOT CONNECTION DETAIL
C2.1 KLS

NOTE: AFTER LINER IS CUT AND PIPE IS INSTALLED, SLIDE BOOT AGAINST LINER AND SECURE WITH A STAINLESS STEEL BAND. THEN RING BOOT TO LINER AND SEAL END OF BOOT WITH SILICONE. REPLACE ANY GEOTEXTILE PROTECTION FABRIC REMOVED DURING BOOT INSTALLATION PROCESS.

THE EAST GROUP
 Engineering Architecture
 Surveying Technology

Corporate Office
 324 Evans Street
 Greenville, NC 27858
 P: 252.758.3746
 F: 252.830.3954

Branch Office
 4325 Lake Boone Trail, Suite 311
 Raleigh, NC 27607
 P: 919.784.9330
 F: 919.784.9331

NC Engineering Lic. No. C-0206
 NC Architectural Lic. No. 50213
 NC Landscape Architectural Lic. No. C-427

NORTH CAROLINA
 PROFESSIONAL
 SEAL
 17480
 ENGINEER
 JODI ALAN THOMPSON

REV#	DATE	DESCRIPTION	BY

TEG PROJECT NO. 20240091

CLIENT PROJECT NO.

PROJECT TITLE
**COG STALLING STADIUM
 DRAINAGE IMPROVEMENTS**
 1055 S ELM STREET
 GREENVILLE, 27858
 PITT COUNTY

SHEET NAME
CONSTRUCTION DETAILS

SHEET NO.
 C2.1

K:\CADD\2024\0091 COG Stallng Stad Drainage\CD\Comp\Proj\DWG\SHEET\Sheet Set\C2.1.dwg