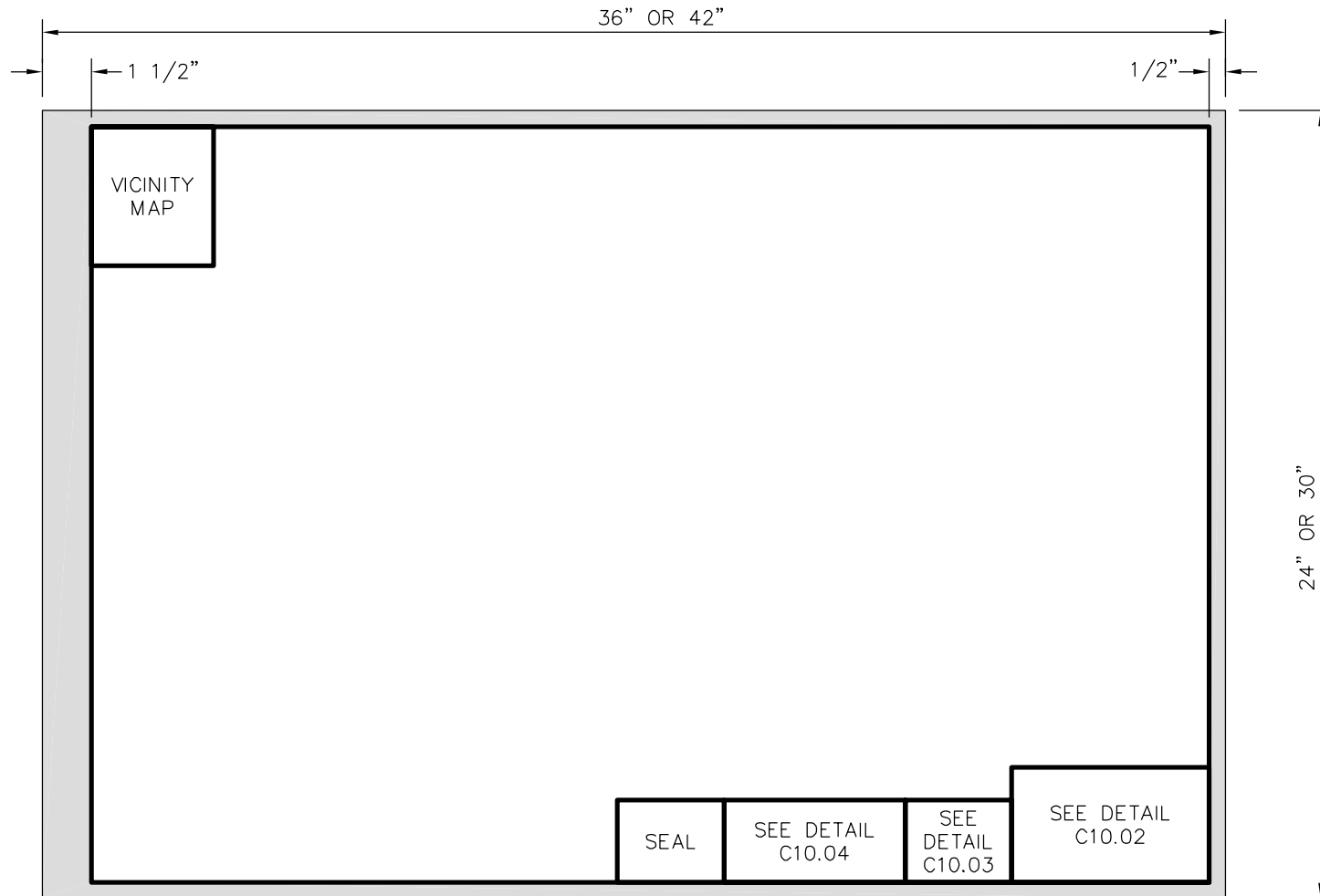

TABLE OF DETAILS

Detail Number	Title
Plat Preparation Standard Sizes and Certificates Details	
C10.01	Standard Preliminary Plat Layout
C10.02	Standard Title Block for Preliminary Plat
C10.03	Standard "Approvals" Information Block
C10.04	Preliminary Plat Surveyor's Certification Using Traditional Only Survey Methods
C10.05	Preliminary Plat Surveyor's Certification Using Traditional and GPS Survey Methods
C11.01	Standard Final Plat Layout
C11.02	Standard Title Block for Final Plats
C11.03	Standard "Source of Title" Information Block
C11.04	Standard Owners Statement Block
C11.05	Standard "Approvals" Information Block
C11.06	Standard Dedication Information Block
C11.07	Final Plat Surveyor's Certification – Traditional Only Survey Methods
C11.08	Final Plat Surveyor's Certification – Traditional and GPS Survey Methods
C11.09	Final Plat Review Officer's Certification
C12.01	Standard Format Annexation Map
C12.02	Annexation Map Surveyor's Certification – Traditional Only Survey Methods
C12.03	Annexation Map Surveyor's Certification – Traditional and GPS Survey Methods
C12.04	Annexation Map Review Officer's Certification
C13.01	Standard P.U.D. Land Use Plan Layout
C13.02	Standard Title Block for P.U.D. Land Use Plan
C13.03	Standard "Approvals" Information Block
C13.04	P.U.D. Land Use Plan Surveyor's Certification – Traditional Only Survey Methods
C13.05	P.U.D. Land Use Plan Surveyor's Certification – Traditional and GPS Survey Methods



PUBLIC WORKS DEPARTMENT
1500 Beatty Street
Greenville, North Carolina 27834

CITY OF GREENVILLE, N.C.
USE WITH THE CITY OF GREENVILLE, N.C. STANDARD SPECIFICATIONS ONLY

www.greenvillenc.gov

No.	Date	Description
1	9/16/11	APPROVAL
Scale: not to scale	Sheet #: 1 of 1	Detail # C10.01

STANDARD PRELIMINARY PLAT LAYOUT

<div style="display: flex; justify-content: space-between; margin-bottom: 10px;"> 6" </div> <div style="display: flex; justify-content: space-between;"> <div style="width: 45%;"> <p>(NAME)</p> <p>SECTION (NO.)</p> <p>CITY, TOWNSHIP, PITT COUNTY, N.C.</p> </div> <div style="width: 45%;"> <p>SUBDIVISION</p> <p>(REVISION NO.)</p> </div> </div>		1 1/2"	
OWNER(S) _____ ADDRESS _____ PHONE _____		1"	
FIRM NAME ADDRESS ADDRESS PHONE # FIRM LICENSE NO.	SURVEYED: DRAWN: CHECKED:	APPROVED: DATE: SCALE:	5/16" 5/16" 3/8"

2"



PUBLIC WORKS DEPARTMENT
1500 Beatty Street
Greenville, North Carolina 27834

CITY OF GREENVILLE, N.C.

USE WITH THE CITY OF GREENVILLE, N.C. STANDARD SPECIFICATIONS ONLY

www.greenvillenc.gov

No.	Date	Description
1	9/16/11	APPROVAL
Scale: not to scale	Sheet #: 1 of 1	Detail # C10.02

STANDARD TITLE BLOCK FOR PRELIMINARY PLAT

3 1/4"

APPROVAL

THIS PRELIMINARY PLAT, # _____, AND THE
STREET NAME(S) HEREON WERE
APPROVED BY THE GREENVILLE PLANNING
AND ZONING COMMISSION AT A MEETING
HELD THE _____ DAY OF _____
20____.

SIGNED _____
CHAIRMAN

SIGNED _____
CITY PLANNER

2 1/2"



PUBLIC WORKS DEPARTMENT
1500 Beatty Street
Greenville, North Carolina 27834

CITY OF GREENVILLE, N.C.

USE WITH THE CITY OF GREENVILLE, N.C. STANDARD SPECIFICATIONS ONLY

www.greenvillenc.gov

No.	Date	Description
1	9/16/11	APPROVAL
Scale: not to scale	Sheet #: 1 of 1	Detail # C10.03

STANDARD "APPROVALS" INFORMATION BLOCK

COMMENTS:

THE SURVEYOR'S CERTIFICATION SHALL BE SUBSTANTIALLY IN THE FORM SHOWN FOR SURVEYS MADE BY TRADITIONAL SURVEY METHODS; FOR SURVEYS PERFORMED USING BOTH TRADITIONAL AND GPS SURVEYING METHODS USE MSDD STANDARD C13.05. THE SURVEYOR SHOULD REFER TO AND COMPLY WITH THE CURRENT NCBELS RULES 21 NCAC 56.1600, "STANDARDS OF PRACTICE OF LAND SURVEYING IN NORTH CAROLINA", AND G.S. 47-30 FOR ANY RULE AMENDMENTS.

www.ncbels.org

REQUIRED MINIMUM ACCURACY STANDARDS: (21 NCAC 56.1603 & .1605)

HORIZONTAL: "URBAN LAND SURVEYS", CLASS "A" (1:10,000+)

VERTICAL: "URBAN AND SUBURBAN VERTICAL CONTROL SURVEYS", CLASS "A"

(Error not to exceed 0.10 times the square root of the numbers of miles run from reference station).

SURVEYOR'S CERTIFICATION

I, _____, CERTIFY THAT THIS PROJECT WAS COMPLETED UNDER MY DIRECT AND RESPONSIBLE CHARGE FROM AN ACTUAL GROUND SURVEY MADE UNDER MY SUPERVISION (DEED DESCRIPTION RECORDED IN BOOK _____, PAGE _____, OR FROM BOOKS REFERENCED HEREON); THAT THE BOUNDARIES NOT SURVEYED ARE CLEARLY INDICATED AS DRAWN FROM INFORMATION FOUND IN BOOK _____, PAGE _____, OR AS REFERENCED HEREON; THAT THE RATIO OF PRECISION AS CALCULATED IS 1:_____; THAT THIS TOPOGRAPHIC SURVEY WAS PERFORMED TO MEET FEDERAL GEOGRAPHIC DATA COMMITTED STANDARDS AS APPLICABLE; THAT THE TOPOGRAPHIC DATA WAS OBTAINED ON (insert dates) _____; THAT THE SURVEY WAS COMPLETED ON (insert date) _____; THAT THE CONTOURS SHOWN AS BROKEN LINES MAY NOT MEET THE STATED STANDARD; THAT VERTICAL CONTROL WAS ESTABLISHED AT THE SITE TO THE CLASS "A" STANDARD; AND THAT THIS MAP MEETS THE REQUIREMENTS OF THE "STANDARD OF PRACTICE FOR LAND SURVEYING IN NORTH CAROLINA" (21 NCAC 56.1600).

WITNESS MY ORIGINAL SIGNATURE AND SEAL THIS THE _____ DAY OF _____, 20 ____.

SIGNED _____

PROFESSIONAL LAND SURVEYOR NO. L- #####

2 1/2"

5 1/2"



PUBLIC WORKS DEPARTMENT
1500 Beatty Street
Greenville, North Carolina 27834

CITY OF GREENVILLE, N.C.

USE WITH THE CITY OF GREENVILLE, N.C. STANDARD SPECIFICATIONS ONLY

www.greenvillenc.gov

No.	Date	Description
1	9/16/11	APPROVAL
Scale: not to scale	Sheet #: 1 of 1	Detail # C10.04

PRELIMINARY PLAT SURVEYOR'S CERTIFICATION USING TRADITIONAL ONLY SURVEY METHODS

COMMENTS:

THE SURVEYOR'S CERTIFICATION SHALL BE SUBSTANTIALLY IN THE FORM SHOWN FOR SURVEYS MADE BY BOTH TRADITIONAL AND GPS SURVEY METHODS. FOR TRADITIONAL ONLY SURVEYS USE MSDD STANDARD C11.07. THE SURVEYOR SHOULD REFER TO AND COMPLY WITH THE CURRENT NCBELS RULES 21 NCAC 56.1600, "STANDARDS OF PRACTICE OF LAND SURVEYING IN NORTH CAROLINA", AND G.S. 47-30 FOR ANY RULE AMENDMENTS. www.ncbels.org

REQUIRED MINIMUM ACCURACY STANDARDS: (21 NCAC 56.1603 & .1605)

HORIZONTAL: "URBAN LAND SURVEYS", CLASS "A" (1:10,000+), GPS (0.07 feet+/- 50PPM or less).

VERTICAL: "URBAN AND SUBURBAN VERTICAL CONTROL SURVEYS", CLASS "A" (Error not to exceed 0.10 times the square root of the numbers of miles run from reference station).

REFERENCE INFORMATION REQUIRED FOR GPS SURVEYS IN THE CERTIFICATION. (REF, NCBELS BOARD RULE 21 NCAC 56.1607).

- (1) POSITIONAL ACCURACY: _____ (0.07 feet +/- 50PPM or less).
 (2) TYPE OF GPS FIELD PROCEDURE: _____ (STATIC, REAL-TIME KINEMATIC, REAL-TIME KINEMATIC NETWORK, ONLINE POSITION USER SERVICE).
 (3) DATE(S) OF SURVEY: _____
 (4) DATUM / EPOCH: _____ (HORIZONTAL (NAD83/86, NAD83(NSRS2007), etc.; VERTICAL (NAVD88)).
 (5) PUBLISHED / FIXED-CONTROL STATIONS USED: _____ (INCLUDE: STATION NAMES, HORIZONTAL POSITION (NORTHING AND EASTING), ELEVATION, DATUM AND EPOCH).
 (6) GEOID MODEL USED: _____ (GEOID03, GEOID06, GEOID09, etc.).
 (7) COMBINED GRID FACTOR(S): _____
 (8) UNITS: _____.

SURVEYOR'S CERTIFICATION

I, _____, CERTIFY THAT THIS PROJECT WAS COMPLETED UNDER MY DIRECT AND RESPONSIBLE CHARGE FROM AN ACTUAL GROUND SURVEY MADE UNDER MY SUPERVISION (DEED DESCRIPTION RECORDED IN BOOK _____, PAGE _____, OR FROM BOOKS REFERENCED HEREON); THAT THE BOUNDARIES NOT SURVEYED ARE CLEARLY INDICATED AS DRAWN FROM INFORMATION FOUND IN BOOK _____, PAGE _____. OR AS REFERENCED HEREON; THAT THE RATIO OF PRECISION AS CALCULATED IS 1:_____; THAT THIS TOPOGRAPHIC SURVEY WAS PERFORMED TO MEET FEDERAL GEOGRAPHIC DATA COMMITTED STANDARDS AS APPLICABLE; THAT THE TOPOGRAPHIC DATA WAS OBTAINED ON (insert dates) _____; THAT THE SURVEY WAS COMPLETED ON (insert dates) _____; THAT THE CONTOURS SHOWN AS BROKEN LINES MAY NOT MEET THE STATED STANDARD; THAT VERTICAL CONTROL WAS ESTABLISHED AT THE SITE TO THE CLASS "A" STANDARD; THAT A GLOBAL POSITIONING SYSTEM (GPS) SURVEY WAS PERFORMED TO ESTABLISH THE HORIZONTAL AND VERTICAL CONTROL FOR THE PROJECT; THAT THE (GPS) OBSERVATIONS WERE PERFORMED TO THE GEOSPATIAL POSITIONING ACCURACY STANDARDS, PART 2: STANDARDS FOR GEODETIC NETWORKS AT THE CLASS "A" ACCURACY CLASSIFICATION (95% CONFIDENCE) AND THE FOLLOWING INFORMATION WAS USED TO PERFORM THE GPS SURVEY:

POSITION ACCURACY: _____ TYPE OF GPS FIELD PROCEDURE: _____ DATE(S) OF SURVEY: _____
 DATUM / EPOCH: _____ GEOID MODEL: _____ UNITS: _____
 PUBLISHED / FIELD CONTROL MONUMENTS USED: _____

AND THAT THIS MAP MEETS THE REQUIREMENTS OF "THE STANDARDS OF PRACTICE FOR LAND SURVEYING IN NORTH CAROLINA" (21 NCAC 56.1600).

WITNESS MY ORIGINAL SIGNATURE AND SEAL THIS TIME _____ DAY OF _____, 20____. SIGNED _____

PROFESSIONAL LAND SURVEYOR NO. L-####

9 1/4"

2 1/2"



PUBLIC WORKS DEPARTMENT
1500 Beatty Street
Greenville, North Carolina 27834

CITY OF GREENVILLE, N.C.

USE WITH THE CITY OF GREENVILLE, N.C. STANDARD SPECIFICATIONS ONLY

www.greenvillenc.gov

No.	Date	Description
1	9/16/11	APPROVAL
Scale: not to scale	Sheet #: 1 of 1	Detail # C10.05

PRELIMINARY PLAT SURVEYOR'S CERTIFICATION USING TRADITIONAL AND GPS SURVEY METHODS

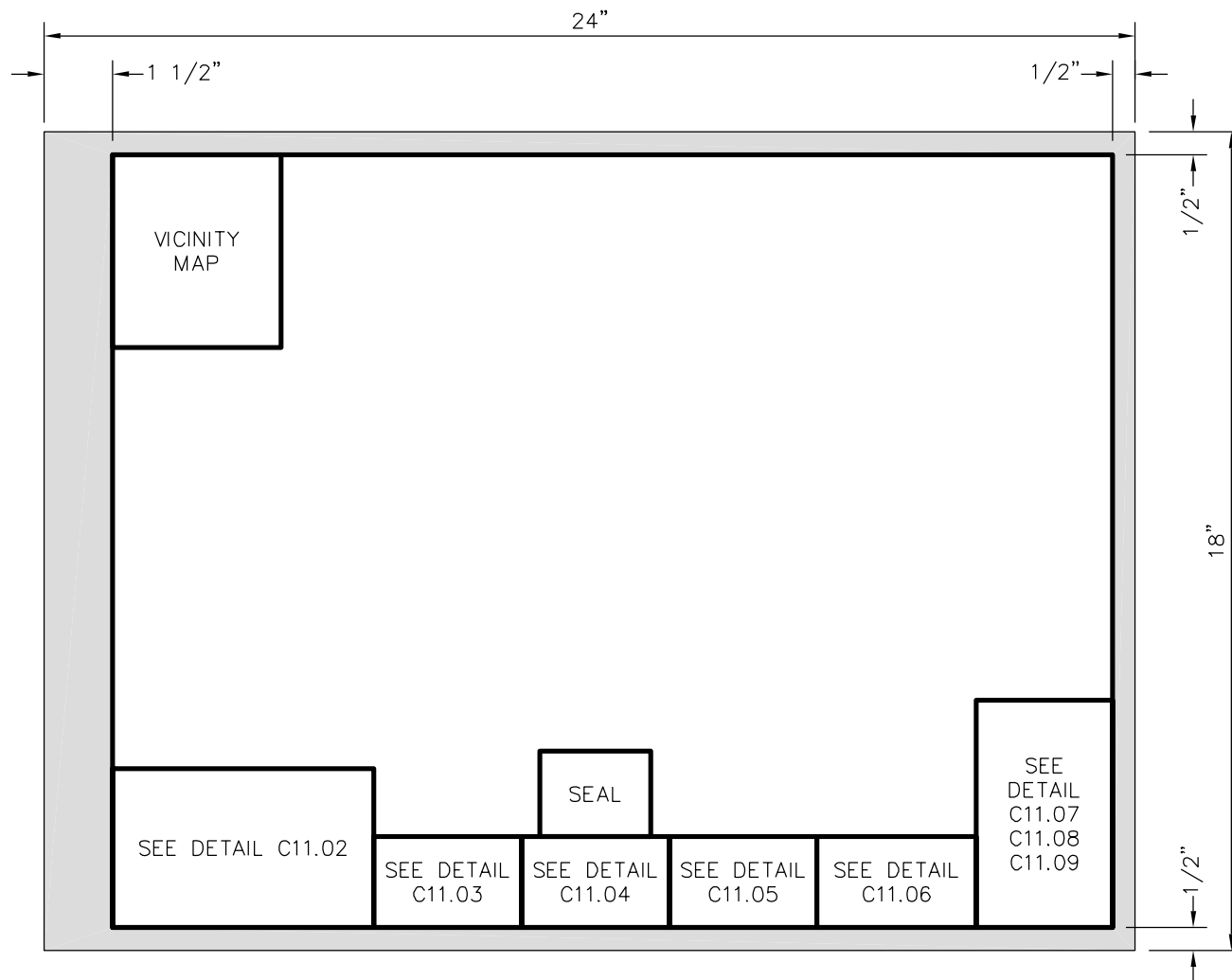

NOTES:

1. Original to be on mylar, 0.003-0.004 inch thickness.
2. Reserve area for Register of Deeds sticker.



PUBLIC WORKS DEPARTMENT
1500 Beatty Street
Greenville, North Carolina 27834

CITY OF GREENVILLE, N.C.

USE WITH THE CITY OF GREENVILLE, N.C. STANDARD SPECIFICATIONS ONLY

www.greenvillenc.gov

No.	Date	Description
1	9/16/11	APPROVAL
Scale: not to scale	Sheet #: 1 of 1	Detail # C11.01

STANDARD FINAL PLAT LAYOUT

5 3/4"		
(NAME) SUBDIVISION SECTION (NO.) (REVISION NO.) CITY, TOWNSHIP, PITT COUNTY, N.C.		1 1/2"
OWNER(S) _____ ADDRESS _____ PHONE _____		1"
FIRM NAME ADDRESS ADDRESS PHONE # FIRM LICENSE NO.	SURVEYED:	APPROVED:
	DRAWN:	DATE:
	CHECKED:	SCALE:
		5/16"
		5/16"
		3/8"
2"		



PUBLIC WORKS DEPARTMENT
1500 Beatty Street
Greenville, North Carolina 27834

CITY OF GREENVILLE, N.C.

USE WITH THE CITY OF GREENVILLE, N.C. STANDARD SPECIFICATIONS ONLY

www.greenvillenc.gov

No.	Date	Description
1	9/16/11	APPROVAL
Scale: not to scale	Sheet #: 1 of 1	Detail # C11.02

STANDARD TITLE BLOCK FOR FINAL PLATS

3 1/4"

SOURCE OF TITLE

THIS IS TO CERTIFY THAT THE LAST
INSTRUMENT(S) IN THE CHAIN OF TITLE(S)
OF THIS PROPERTY AS RECORDED IN THE
PITT COUNTY REGISTRY AT GREENVILLE,
NORTH CAROLINA IS:

DEED BOOK _____ PAGE _____

DEED BOOK _____ PAGE _____

DEED BOOK _____ PAGE _____

_____ N.C. LIC. NO.

2"



PUBLIC WORKS DEPARTMENT
1500 Beatty Street
Greenville, North Carolina 27834

CITY OF GREENVILLE, N.C.

USE WITH THE CITY OF GREENVILLE, N.C. STANDARD SPECIFICATIONS ONLY

www.greenvillenc.gov

No.	Date	Description
1	9/16/11	APPROVAL
Scale: not to scale	Sheet #: 1 of 1	Detail # C11.03

STANDARD "SOURCE OF TITLE" INFORMATION BLOCK

3 1/4"

OWNERS STATEMENT
 THIS IS EVIDENCE THAT THIS SUB-DIVISION
 IS MADE AT THE REQUEST OF _____

SWORN AND SUBSCRIBED TO BEFORE
 ME THIS _____ DAY OF _____ 20 _____

 NOTARY PUBLIC
 MY COMMISSION EXPIRES _____

2"



PUBLIC WORKS DEPARTMENT
 1500 Beatty Street
 Greenville, North Carolina 27834

CITY OF GREENVILLE, N.C.

USE WITH THE CITY OF GREENVILLE, N.C. STANDARD SPECIFICATIONS ONLY

www.greenvillenc.gov

No.	Date	Description
1	9/16/11	APPROVAL
Scale: not to scale	Sheet #: 1 of 1	Detail # C11.04

STANDARD OWNERS STATEMENT BLOCK

3 1/4"

APPROVAL

THIS PRELIMINARY PLAT, # _____, AND THE
STREET NAME(S) HEREON WERE
APPROVED BY THE GREENVILLE PLANNING
AND ZONING COMMISSION AT A MEETING
HELD THE _____ DAY OF _____
20____.

SIGNED _____
CHAIRMAN

SIGNED _____
CITY PLANNER

2"



PUBLIC WORKS DEPARTMENT
1500 Beatty Street
Greenville, North Carolina 27834

CITY OF GREENVILLE, N.C.

USE WITH THE CITY OF GREENVILLE, N.C. STANDARD SPECIFICATIONS ONLY

www.greenvillenc.gov

No.	Date	Description
1	9/16/11	APPROVAL
Scale: not to scale	Sheet #: 1 of 1	Detail # C11.05

STANDARD "APPROVALS" INFORMATION BLOCK

3 1/2"

DEDICATION

THIS UNDERSIGNED HEREBY AKNOWLEDGE(S)
THIS PLAT AND ALLOTMENT TO BE _____
FREE ACT AND DEED, AND HEREBY DEDICATE(S)
TO PUBLIC USE AS STREETS, PARKS, PLAY-
GROUNDS, OPEN SPACES AND EASEMENTS FOR-
EVER ALL AREAS AS SHOWN OR SO INDICATED
ON SAID PLAT.

SIGNED _____

SIGNED _____

2"



PUBLIC WORKS DEPARTMENT
1500 Beatty Street
Greenville, North Carolina 27834

CITY OF GREENVILLE, N.C.

USE WITH THE CITY OF GREENVILLE, N.C. STANDARD SPECIFICATIONS ONLY

www.greenvillenc.gov

No.	Date	Description
1	9/16/11	APPROVAL
Scale: not to scale	Sheet #: 1 of 1	Detail # C11.06

STANDARD DEDICATION INFORMATION BLOCK

COMMENTS:

THE SURVEYOR'S CERTIFICATION SHALL BE SUBSTANTIALLY IN THE FORM SHOWN FOR SURVEYS MADE BY TRADITIONAL SURVEY METHODS; FOR SURVEYS PERFORMED USING BOTH TRADITIONAL AND GPS SURVEYING METHODS, USE MSDD STANDARD C11.08. THE SURVEYOR SHOULD REFER TO AND COMPLY WITH THE CURRENT NCBELS RULES 21 NCAC 56.1600, "STANDARDS OF PRACTICE OF LAND SURVEYING IN NORTH CAROLINA", AND G.S. 47-30 FOR ANY RULE AMENDMENTS.

www.ncbels.org

REQUIRED MINIMUM ACCURACY STANDARDS: (21 NCAC 56.1603 & .1605)

HORIZONTAL: "URBAN LAND SURVEYS", CLASS "A" (1:10,000+)

VERTICAL: "URBAN AND SUBURBAN VERTICAL CONTROL SURVEYS", CLASS "A"

(Error not to exceed 0.10 times the square root of the numbers of miles run from reference station).

SURVEYOR'S CERTIFICATION

I, _____, CERTIFY THAT THIS PLAT WAS
DRAWN UNDER MY SUPERVISION FROM AN ACTUAL
FIELD SURVEY PERFORMED UNDER MY SUPERVISION
(DEED DESCRIPTION RECORDED IN BOOK _____, PAGE
_____, OR FROM BOOKS REFERENCED HEREON); THAT
THE BOUNDARIES NOT SURVEYED ARE CLEARLY
INDICATED AS DRAWN FROM INFORMATION FOUND IN
BOOK _____, PAGE _____, OR AS REFERENCED
HEREON; THAT THE RATIO OF PRECISION AS
CALCULATED IS 1:_____; THAT THIS PLAT WAS
PREPARED IN ACCORDANCE WITH G.S. 47-30 AS
AMENDED.

I FURTHER CERTIFY PURSUANT TO G.S. 47-30 (f) (11) (a).
THIS SURVEY CREATES A SUBDIVISION OF LAND WITHIN
A COUNTY OR MUNICIPALITY THAT HAS AN ORDINANCE
THAT REGULATES PARCELS OF LAND.

WITNESS MY ORIGINAL SIGNATURE AND SEAL THIS THE
_____ DAY OF _____, 20 ____.

SIGNED _____
PROFESSIONAL LAND SURVEYOR NO. L- ####

3"

5"



PUBLIC WORKS DEPARTMENT
1500 Beatty Street
Greenville, North Carolina 27834

CITY OF GREENVILLE, N.C.

USE WITH THE CITY OF GREENVILLE, N.C. STANDARD SPECIFICATIONS ONLY

www.greenvillenc.gov

No.	Date	Description
1	9/16/11	APPROVAL
Scale: not to scale	Sheet #: 1 of 1	Detail # C11.07

FINAL PLAT SURVEYOR'S CERTIFICATION - TRADITIONAL ONLY SURVEY METHODS

COMMENTS:

THE SURVEYOR'S CERTIFICATION SHALL BE SUBSTANTIALLY IN THE FORM SHOWN FOR SURVEYS MADE BY TRADITIONAL AND GPS SURVEY METHODS. FOR TRADITIONAL ONLY SURVEYS USE MSDD STANDARD C11.07. THE SURVEYOR SHOULD REFER TO AND COMPLY WITH THE CURRENT NCBELS RULES 21 NCAC 56.1600, "STANDARDS OF PRACTICE OF LAND SURVEYING IN NORTH CAROLINA", AND G.S. 47-30 FOR ANY RULE AMENDMENTS. www.ncbels.org

REQUIRED MINIMUM ACCURACY STANDARDS: (21 NCAC 56.1603 & .1605)

HORIZONTAL: "URBAN LAND SURVEYS", CLASS "A" (1:10,000+)

VERTICAL: "URBAN AND SUBURBAN VERTICAL CONTROL SURVEYS", CLASS "A"
(Error not to exceed 0.10 times the square root of the numbers of miles run from reference station).

REFERENCE INFORMATION REQUIRED FOR GPS SURVEYS IN THE CERTIFICATION. (REF, NCBELS BOARD RULE 21 NCAC 56.1607).

- (1) POSITIONAL ACCURACY: _____ (0.07 feet +/- 50PPM or less).
- (2) TYPE OF GPS FIELD PROCEDURE: _____
(STATIC, REAL-TIME KINEMATIC, REAL-TIME KINEMATIC NETWORK, ONLINE POSITION USER SERVICE).
- (3) DATE(S) OF SURVEY: _____
- (4) DATUM / EPOCH: _____
(HORIZONTAL (NAD83/86, NAD83(NSRS2007), etc.; VERTICAL (NAVD88)).
- (5) PUBLISHED / FIXED-CONTROL STATIONS USED: _____
(INCLUDE: STATION NAMES, HORIZONTAL POSITION (NORTHING AND EASTING), ELEVATION, DATUM AND EPOCH).
- (6) GEOID MODEL USED: _____
(GEOID03, GEOID06, GEOID09, etc.).
- (7) COMBINED GRID FACTOR(S): _____
- (8) UNITS: US SURVEY FOOT.

SURVEYOR'S CERTIFICATION

I, _____, CERTIFY THAT THIS PLAT WAS DRAWN UNDER MY SUPERVISION FROM AN ACTUAL FIELD SURVEY PERFORMED UNDER MY SUPERVISION (DEED DESCRIPTION RECORDED IN BOOK _____, PAGE _____, OR FROM BOOKS REFERENCED HEREON); THAT THE BOUNDARIES NOT SURVEYED ARE CLEARLY INDICATED AS DRAWN FROM INFORMATION FOUND IN BOOK _____, PAGE _____, OR AS REFERENCED HEREON; THAT THE RATIO OF PRECISION FOR TRADITIONAL SURVEY METHOD IS 1: _____; THAT THE GLOBAL POSITIONING SYSTEM (GPS) OBSERVATIONS WERE PERFORMED TO THE GEOSPATIAL POSITIONING ACCURACY STANDARDS, PART 2: STANDARDS FOR GEODETIC NETWORKS AT THE CLASS "A" ACCURACY CLASSIFICATION (95% CONFIDENCE) AND THE FOLLOWING INFORMATION WAS USED TO PERFORM THE GPS SURVEY:

POSITION ACCURACY: _____

TYPE OF GPS FIELD PROCEDURE: _____

DATE(S) OF SURVEY: _____

DATUM / EPOCH: _____

PUBLISHED / FIELD CONTROL MONUMENTS USED: _____

GEOID MODEL: _____

COMBINED GRID FACTOR: _____

UNITS: _____

THAT THIS PLAT WAS PREPARED IN ACCORDANCE WITH G.S. 47-30 AS AMENDED.

I, FURTHER CERTIFY PURSUANT TO G.S.47-30(f)(11)(a), THIS SURVEY CREATES A SUBDIVISION OF LAND WITHIN A COUNTY OR MUNICIPALITY THAT HAS AN ORDINANCE THAT REGULATES PARCELS OF LAND.

WITNESS MY ORIGINAL SIGNATURE AND SEAL THIS THE _____ DAY OF _____, 20 ____.

SIGNED _____ PROFESSIONAL LAND SURVEYOR NO. L-####

5 1/2"

3"



PUBLIC WORKS DEPARTMENT
1500 Beatty Street
Greenville, North Carolina 27834

CITY OF GREENVILLE, N.C.

USE WITH THE CITY OF GREENVILLE, N.C. STANDARD SPECIFICATIONS ONLY

www.greenvillenc.gov

No.	Date	Description
1	9/16/11	APPROVAL
Scale: not to scale	Sheet #: 1 of 1	Detail # C11.08

FINAL PLAT SURVEYOR'S CERTIFICATION - TRADITIONAL & GPS SURVEY METHODS

3"	
REVIEW OFFICER'S CERTIFICATION I, _____, A REVIEW OFFICER OF PITT COUNTY, N.C., CERTIFY THAT THE MAP OR PLAT TO WHICH THIS CERTIFICATION IS AFFIXED MEETS ALL STATUTORY REQUIREMENTS FOR RECORDING. BY _____ REVIEW OFFICER DATE: _____	
2"	



PUBLIC WORKS DEPARTMENT
 1500 Beatty Street
 Greenville, North Carolina 27834

CITY OF GREENVILLE, N.C.

USE WITH THE CITY OF GREENVILLE, N.C. STANDARD SPECIFICATIONS ONLY

www.greenvillenc.gov

No.	Date	Description
1	9/16/11	APPROVAL
Scale: not to scale	Sheet #: 1 of 1	Detail # C11.09

FINAL PLAT REVIEW OFFICER'S CERTIFICATION

1. Original to be on drafting film, 0.003-0.004 inch thickness
2. One film copy for city files.
3. Reserve area for Register of Deeds sticker.



PUBLIC WORKS DEPARTMENT
1500 Beatty Street
Greenville, North Carolina 27834

CITY OF GREENVILLE, N.C.

USE WITH THE CITY OF GREENVILLE, N.C. STANDARD SPECIFICATIONS ONLY

www.greenvillenc.gov

No.	Date	Description
1	9/16/11	APPROVAL

Scale: not to scale	Sheet #: 1 of 1	Detail # C12.01
------------------------	--------------------	---------------------------

STANDARD FORMAT ANNEXATION MAP

COMMENTS:

THE SURVEYORS CERTIFICATION SHALL BE SUBSTANTIALLY IN THE FORM SHOWN FOR SURVEYS MADE BY TRADITIONAL SURVEY METHODS; FOR SURVEYS PERFORMED USING BOTH TRADITIONAL AND GPS SURVEYING METHODS USE MSDD STANDARD C12.03. THE SURVEYOR SHOULD REFER TO AND COMPLY WITH THE CURRENT NCBELS RULES 21 NCAC 56.1600, "STANDARDS OF PRACTICE OF LAND SURVEYING IN NORTH CAROLINA", AND G.S. 47-30 FOR ANY RULE AMENDMENTS.
www.ncbels.org

REQUIRED MINIMUM ACCURACY STANDARDS: (21 NCAC 56.1603 & .1605)

HORIZONTAL: "URBAN LAND SURVEYS", CLASS "A" (1:10,000+)

VERTICAL: "URBAN AND SUBURBAN VERTICAL CONTROL SURVEYS", CLASS "A"
 (Error not to exceed 0.10 times the square root of the numbers of miles run from reference station).

SURVEYOR'S CERTIFICATION

I, _____, CERTIFY THAT THIS PLAT WAS DRAWN UNDER MY SUPERVISION FROM AN ACTUAL FIELD SURVEY PERFORMED UNDER MY SUPERVISION (DEED DESCRIPTION RECORDED IN BOOK _____, PAGE _____, OR FROM BOOKS REFERENCED HEREON); THAT THE BOUNDARIES NOT SURVEYED ARE CLEARLY INDICATED AS DRAWN FROM INFORMATION FOUND IN BOOK _____, PAGE _____, OR AS A REFERENCED HEREON; THAT THE RATIO OF PRECISION AS CALCULATED IS 1:_____; THAT THIS PLAT WAS PREPARED IN ACCORDANCE WITH G.S. 47-30 AS AMENDED.

I FURTHER CERTIFY PURSUANT TO G.S. 47-30 (f) (11) (d). THIS SURVEY IS OF ANOTHER CATEGORY AND IS AN EXEMPTION TO THE DEFINITION OF A SUBDIVISION.

WITNESS MY ORIGINAL SIGNATURE AND SEAL THIS THE _____ DAY OF _____, 20 ____.

SIGNED _____ PROFESSIONAL LAND SURVEYOR NO. L- #####

3"



PUBLIC WORKS DEPARTMENT
 1500 Beatty Street
 Greenville, North Carolina 27834

CITY OF GREENVILLE, N.C.

USE WITH THE CITY OF GREENVILLE, N.C. STANDARD SPECIFICATIONS ONLY

www.greenvillenc.gov

No.	Date	Description
1	9/16/11	APPROVAL
Scale: not to scale	Sheet #: 1 of 1	Detail # C12.02

ANNEXATION MAP SURVEYOR'S CERTIFICATION - TRADITIONAL ONLY SURVEY METHODS

COMMENTS:

THE SURVEYOR'S CERTIFICATION SHALL BE SUBSTANTIALLY IN THE FORM SHOWN FOR SURVEYS MADE BY BOTH TRADITIONAL AND GPS SURVEY METHODS. FOR TRADITIONAL ONLY SURVEYS USE MSDD STANDARD C12.02. THE SURVEYOR SHOULD REFER TO AND COMPLY WITH THE CURRENT NCBELS RULES 21 NCAC 56.1600, "STANDARDS OF PRACTICE OF LAND SURVEYING IN NORTH CAROLINA", AND G.S. 47-30 FOR ANY RULE AMENDMENTS. www.ncbels.org

REQUIRED MINIMUM ACCURACY STANDARDS: (21 NCAC 56.1603 & .1605)

HORIZONTAL: "URBAN LAND SURVEYS", CLASS "A" (1:10,000+)

VERTICAL: "URBAN AND SUBURBAN VERTICAL CONTROL SURVEYS", CLASS "A"
(Error not to exceed 0.10 times the square root of the numbers of miles run from reference station).

REFERENCE INFORMATION REQUIRED FOR GPS SURVEYS IN THE CERTIFICATION. (REF, NCBELS BOARD RULE 21 NCAC 56.1607).

- (1) POSITIONAL ACCURACY: _____ (0.07 feet +/- 50PPM or less).
- (2) TYPE OF GPS FIELD PROCEDURE: _____
(STATIC, REAL-TIME KINEMATIC, REAL-TIME KINEMATIC NETWORK, ONLINE POSITION USER SERVICE).
- (3) DATE(S) OF SURVEY: _____
- (4) DATUM / EPOCH: _____
(HORIZONTAL (NAD83/86, NAD83(NSRS2007), etc.; VERTICAL (NAVD88)).
- (5) PUBLISHED / FIXED-CONTROL STATIONS USED: _____
(INCLUDE: STATION NAMES, HORIZONTAL POSITION (NORTHING AND EASTING), ELEVATION, DATUM AND EPOCH).
- (6) GEOID MODEL USED: _____
(GEOID03, GEOID06, GEOID09, etc.).
- (7) COMBINED GRID FACTOR(S): _____
- (8) UNITS: US SURVEY FOOT.

SURVEYOR'S CERTIFICATION

I, _____, CERTIFY THAT THIS PLAT WAS DRAWN UNDER MY SUPERVISION FROM AN ACTUAL FIELD SURVEY PERFORMED UNDER MY SUPERVISION (DEED DESCRIPTION RECORDED IN BOOK _____, PAGE _____, OR FROM BOOKS REFERENCED HEREON); THAT THE BOUNDARIES NOT SURVEYED ARE CLEARLY INDICATED AS DRAWN FROM INFORMATION FOUND IN BOOK _____, PAGE _____, OR AS REFERENCED HEREON; THAT THE RATIO OF PRECISION FOR TRADITIONAL SURVEY METHOD IS 1: _____; THAT THE GLOBAL POSITIONING SYSTEM (GPS) OBSERVATIONS WERE PERFORMED TO THE GEOSPATIAL POSITIONING ACCURACY STANDARDS, PART 2: STANDARDS FOR GEODETIC NETWORKS AT THE CLASS "A" ACCURACY CLASSIFICATION (95% CONFIDENCE) AND THE FOLLOWING INFORMATION WAS USED TO PERFORM THE GPS SURVEY:

POSITION ACCURACY: _____

TYPE OF GPS FIELD PROCEDURE: _____

DATE(S) OF SURVEY: _____

DATUM / EPOCH: _____

PUBLISHED / FIELD CONTROL MONUMENTS USED: _____

GEOID MODEL: _____

COMBINED GRID FACTOR: _____

UNITS: _____

THAT THIS PLAT WAS PREPARED IN ACCORDANCE WITH G.S. 47-30 AS AMENDED.

I FURTHER CERTIFY PURSUANT TO G.S. 47-30 (f) (11) (d). THIS SURVEY IS OF ANOTHER CATEGORY AND IS AN EXEMPTION TO THE DEFINITION OF A SUBDIVISION.

WITNESS MY ORIGINAL SIGNATURE AND SEAL THIS THE _____ DAY OF _____, 20 ____.

SIGNED _____ PROFESSIONAL LAND SURVEYOR NO. L- #####

5 1/2"

3"



PUBLIC WORKS DEPARTMENT
1500 Beatty Street
Greenville, North Carolina 27834

CITY OF GREENVILLE, N.C.

USE WITH THE CITY OF GREENVILLE, N.C. STANDARD SPECIFICATIONS ONLY

www.greenvillenc.gov

No.	Date	Description
1	9/16/11	APPROVAL
Scale: not to scale	Sheet #: 1 of 1	Detail # C12.03

ANNEXATION MAP SURVEYOR'S CERTIFICATION - TRADITIONAL & GPS SURVEY METHODS

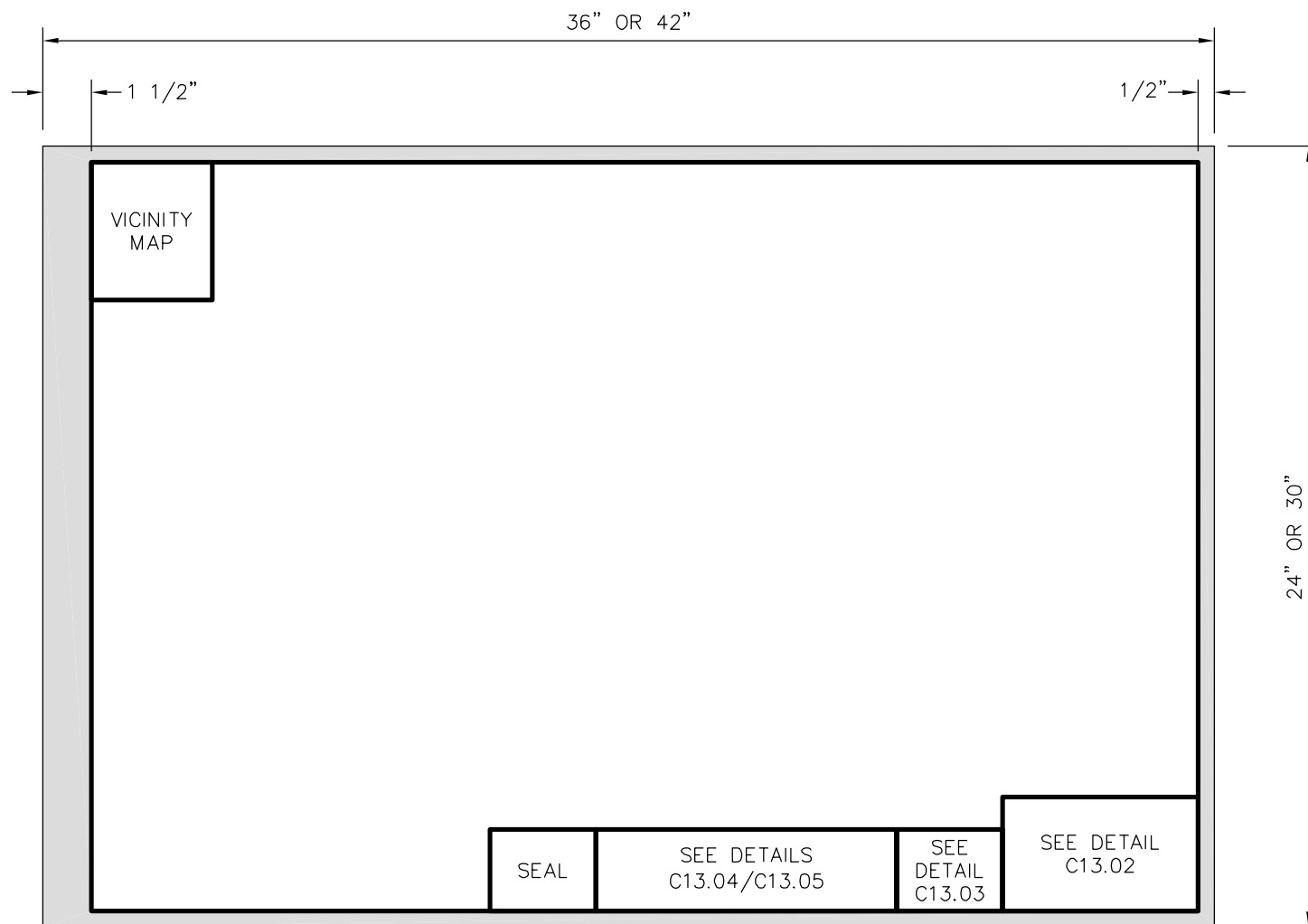

PUBLIC WORKS DEPARTMENT
1500 Beatty Street
Greenville, North Carolina 27834

CITY OF GREENVILLE, N.C.
USE WITH THE CITY OF GREENVILLE, N.C. STANDARD SPECIFICATIONS ONLY

www.greenvillenc.gov

No.	Date	Description
1	9/16/11	APPROVAL
Scale: not to scale	Sheet #: 1 of 1	Detail # C13.01

STANDARD P.U.D. LAND USE PLAN LAYOUT

6"		
<p>(NAME)</p> <p>CITY, TOWNSHIP, PITT COUNTY, N.C.</p>		
1 1/2"		
1"		
<p>OWNER(S) _____</p> <p>ADDRESS _____</p> <p>PHONE _____</p>		
<p>FIRM NAME</p> <p>ADDRESS</p> <p>ADDRESS</p> <p>PHONE #</p> <p>FIRM LICENSE NO.</p>	SURVEYED:	APPROVED:
	DRAWN:	DATE:
	CHECKED:	SCALE:
3/8"		
5/16"		
5/16"		
2"		



PUBLIC WORKS DEPARTMENT
1500 Beatty Street
Greenville, North Carolina 27834

CITY OF GREENVILLE, N.C.

USE WITH THE CITY OF GREENVILLE, N.C. STANDARD SPECIFICATIONS ONLY

www.greenvillenc.gov

No.	Date	Description
1	9/16/11	APPROVAL
Scale: not to scale	Sheet #: 1 of 1	Detail # C13.02

STANDARD TITLE BLOCK FOR P.U.D. LAND USE PLAN

3 1/4"

APPROVAL

THIS PLANNED UNIT DEVELOPMENT LAND
USE PLAN, # _____ WAS
APPROVED BY THE GREENVILLE PLANNING
AND ZONING COMMISSION AT A MEETING
HELD THE _____ DAY OF _____
20____.

SIGNED _____
CHAIRMAN

SIGNED _____
CITY PLANNER

2 1/2"



PUBLIC WORKS DEPARTMENT
1500 Beatty Street
Greenville, North Carolina 27834

CITY OF GREENVILLE, N.C.

USE WITH THE CITY OF GREENVILLE, N.C. STANDARD SPECIFICATIONS ONLY

www.greenvillenc.gov

No.	Date	Description
1	9/16/11	APPROVAL
Scale: not to scale	Sheet #: 1 of 1	Detail # C13.03

STANDARD "APPROVALS" INFORMATION BLOCK

COMMENTS:

THE SURVEYOR'S CERTIFICATION SHALL BE SUBSTANTIALLY IN THE FORM SHOWN FOR SURVEYS MADE BY TRADITIONAL SURVEY METHODS; FOR SURVEYS PERFORMED USING BOTH TRADITIONAL AND GPS SURVEYING METHODS USE MSDD STANDARD C13.05. THE SURVEYOR SHOULD REFER TO AND COMPLY WITH THE CURRENT NCBELS RULES 21 NCAC 56.1600, "STANDARDS OF PRACTICE OF LAND SURVEYING IN NORTH CAROLINA", AND G.S. 47-30 FOR ANY RULE AMENDMENTS.

www.ncbels.org

REQUIRED MINIMUM ACCURACY STANDARDS: (21 NCAC 56.1603 & .1605)

HORIZONTAL: "URBAN LAND SURVEYS", CLASS "A" (1:10,000+)

VERTICAL: "URBAN AND SUBURBAN VERTICAL CONTROL SURVEYS", CLASS "A"

(Error not to exceed 0.10 times the square root of the numbers of miles run from reference station).

SURVEYOR'S CERTIFICATION

I, _____, CERTIFY THAT THIS PROJECT WAS COMPLETED UNDER MY DIRECT AND RESPONSIBLE CHARGE FROM AN ACTUAL GROUND SURVEY MADE UNDER MY SUPERVISION (DEED DESCRIPTION RECORDED IN BOOK _____, PAGE _____, OR FROM BOOKS REFERENCED HEREON); THAT THE BOUNDARIES NOT SURVEYED ARE CLEARLY INDICATED AS DRAWN FROM INFORMATION FOUND IN BOOK _____, PAGE _____. OR AS REFERENCED HEREON; THAT THE RATIO OF PRECISION AS CALCULATED IS 1:_____; THAT THIS TOPOGRAPHIC SURVEY WAS PERFORMED TO MEET FEDERAL GEOGRAPHIC DATA COMMITTED STANDARDS AS APPLICABLE; THAT THE TOPOGRAPHIC DATA WAS OBTAINED ON (insert dates) _____; THAT THE SURVEY WAS COMPLETED ON (insert date) _____; THAT THE CONTOURS SHOWN AS BROKEN LINES MAY NOT MEET THE STATED STANDARD; THAT VERTICAL CONTROL WAS ESTABLISHED AT THE SITE TO THE CLASS "A" STANDARD; AND THAT THIS MAP MEETS THE REQUIREMENTS OF THE "STANDARD OF PRACTICE FOR LAND SURVEYING IN NORTH CAROLINA" (21 NCAC 56.1600).

WITNESS MY ORIGINAL SIGNATURE AND SEAL THIS THE _____ DAY OF _____, 20 ____.

SIGNED _____

PROFESSIONAL LAND SURVEYOR NO. L- #####

2 1/2"

5 1/2"



PUBLIC WORKS DEPARTMENT
1500 Beatty Street
Greenville, North Carolina 27834

CITY OF GREENVILLE, N.C.

USE WITH THE CITY OF GREENVILLE, N.C. STANDARD SPECIFICATIONS ONLY

www.greenvillenc.gov

No.	Date	Description
1	9/16/11	APPROVAL
Scale: not to scale	Sheet #: 1 of 1	Detail # C13.04

P.U.D. LAND USE PLAN SURVEYOR'S CERTIFICATION - TRADITIONAL ONLY SURVEY METHODS

COMMENTS:

THE SURVEYOR'S CERTIFICATION SHALL BE SUBSTANTIALLY IN THE FORM SHOWN FOR SURVEYS MADE BY BOTH TRADITIONAL AND GPS SURVEY METHODS. FOR TRADITIONAL ONLY SURVEYS USE MSDD STANDARD C13.04. THE SURVEYOR SHOULD REFER TO AND COMPLY WITH THE CURRENT NCBELS RULES 21 NCAC 56.1600, "STANDARDS OF PRACTICE OF LAND SURVEYING IN NORTH CAROLINA", AND G.S. 47-30 FOR ANY RULE AMENDMENTS. www.ncbels.org

REQUIRED MINIMUM ACCURACY STANDARDS: (21 NCAC 56.1603 & .1605)

HORIZONTAL: "URBAN LAND SURVEYS", CLASS "A" (1:10,000+), GPS (0.07 feet+/- 50PPM or less).

VERTICAL: "URBAN AND SUBURBAN VERTICAL CONTROL SURVEYS", CLASS "A" (Error not to exceed 0.10 times the square root of the numbers of miles run from reference station).

REFERENCE INFORMATION REQUIRED FOR GPS SURVEYS IN THE CERTIFICATION. (REF, NCBELS BOARD RULE 21 NCAC 56-1607).

- (1) POSITIONAL ACCURACY: _____ (0.07 feet +/- 50PPM or less).
 (2) TYPE OF GPS FIELD PROCEDURE: _____ (STATIC, REAL-TIME KINEMATIC, REAL-TIME KINEMATIC NETWORK, ONLINE POSITION USER SERVICE).
 (3) DATE(S) OF SURVEY: _____
 (4) DATUM / EPOCH: _____ (HORIZONTAL (NAD83/86, NAD83(NSRS2007), etc.; VERTICAL (NAVD88)).
 (5) PUBLISHED / FIXED-CONTROL STATIONS USED: _____ (INCLUDE: STATION NAMES, HORIZONTAL POSITION (NORTHING AND EASTING), ELEVATION, DATUM AND EPOCH).
 (6) GEOID MODEL USED: _____ (GEOID03, GEOID06, GEOID09, etc.).
 (7) COMBINED GRID FACTOR(S): _____
 (8) UNITS: US SURVEY FOOT.

SURVEYOR'S CERTIFICATION

I, _____, CERTIFY THAT THIS PROJECT WAS COMPLETED UNDER MY DIRECT AND RESPONSIBLE CHARGE FROM AN ACTUAL GROUND SURVEY MADE UNDER MY SUPERVISION (DEED DESCRIPTION RECORDED IN BOOK _____, PAGE _____, OR FROM BOOKS REFERENCED HEREON); THAT THE BOUNDARIES NOT SURVEYED ARE CLEARLY INDICATED AS DRAWN FROM INFORMATION FOUND IN BOOK _____, PAGE _____, OR AS REFERENCED HEREON; THAT THE RATIO OF PRECISION AS CALCULATED IS 1: _____; THAT THIS TOPOGRAPHIC SURVEY WAS PERFORMED TO MEET FEDERAL GEOGRAPHIC DATA COMMITTED STANDARDS AS APPLICABLE; THAT THE TOPOGRAPHIC DATA WAS OBTAINED ON (insert dates); THAT THE SURVEY WAS COMPLETED ON (insert dates); THAT THE CONTOURS SHOWN AS BROKEN LINES MAY NOT MEET THE STATED STANDARD; THAT VERTICAL CONTROL WAS ESTABLISHED AT THE SITE TO THE CLASS "A" STANDARD; THAT A GLOBAL POSITIONING SYSTEM (GPS) SURVEY WAS PERFORMED TO ESTABLISH THE HORIZONTAL AND VERTICAL CONTROL FOR THE PROJECT; THAT THE (GPS) OBSERVATIONS WERE PERFORMED TO THE GEOSPATIAL POSITIONING ACCURACY STANDARDS, PART 2: STANDARDS FOR GEODETIC NETWORKS AT THE CLASS "A" ACCURACY CLASSIFICATION (95% CONFIDENCE) AND THE FOLLOWING INFORMATION WAS USED TO PERFORM THE GPS SURVEY:

POSITION ACCURACY: _____ TYPE OF GPS FIELD PROCEDURE: _____ DATE(S) OF SURVEY: _____
 DATUM / EPOCH: _____ GEOID MODEL: _____ UNITS: _____
 PUBLISHED / FIELD CONTROL MONUMENTS USED: _____

AND THAT THIS MAP MEETS THE REQUIREMENTS OF "THE STANDARDS OF PRACTICE FOR LAND SURVEYING IN NORTH CAROLINA" (21 NCAC 56.1600).

WITNESS MY ORIGINAL SIGNATURE AND SEAL THIS THE _____ DAY OF _____, 20____.

SIGNED _____
 PROFESSIONAL LAND SURVEYOR NO. L-L-####

9 1/4"

2 1/2"



PUBLIC WORKS DEPARTMENT
 1500 Beatty Street
 Greenville, North Carolina 27834

CITY OF GREENVILLE, N.C.

USE WITH THE CITY OF GREENVILLE, N.C. STANDARD SPECIFICATIONS ONLY

www.greenvillenc.gov

No.	Date	Description
1	9/16/11	APPROVAL
Scale: not to scale	Sheet #: 1 of 1	Detail # C13.05

P.U.D. LAND USE PLAN SURVEYOR'S CERTIFICATION - TRADITIONAL & GPS SURVEY METHODS